

JAN 12 2016

AT _____ O'CLOCK _____ M
KYLE J. FRANSON
REGISTER OF DEEDS

U.S. PUBLIC LAND SURVEY MONUMENT RECORD

Note: This form is intended and designed to fulfill all requirements of Wisconsin Administrative Code, Chapter A-E 7.08 U.S. Public Land Survey Monument Record (3) (a) (b) (c) (d) (e) (f) (g) (h) (i). An additional sheet may be added if necessary to conform with said requirements.

(a) CORNER LOCATION: WISCORS - Oneida County
1/4 Cor. of Secs. 4 & 5 N: 131,993.09 USft
Township 35 North E: 270,901.55 USft
Range 9 East of the 4th P.M. Datum: NAD 1983(2011)
Town of Enterprise County of Oneida

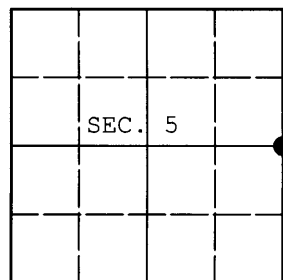

(b) HISTORY OF ORIGINAL CORNER ESTABLISHMENT

Original Surveyor: James L. Nowlin Original Accessories:
Date of Survey: Commenced: Oct. 5, 1864 tamarack 8" S30°W, 33 lks.
Completed: Nov. 3, 1864 tamarack 7" S42°E, 44 lks.

(b) (f) (g) (h) Description of monument found at this corner and if it was accepted, state all evidence (material, testimonial, occupational, plats, records, other monuments) used as a basis for accepting. If not accepted or if nothing was found, state evidence used as basis for establishing location. If re-established through lost corner proportionate methods, indicate all monuments, distances and directions used to establish. Indicate type of monument and sign post found or set.

October 27, 1908: In old fieldbook 6 on page 54, after running the centerline of Sec. 4, D.H. Vaughan "found SE BT down, the SW one is a stub 3-1/2 ft. high. Marks are plain on both, set post."

November 18, 2015: At a search location determined from measurements made to Vaughan's corners North, West and East, I found the following: Lying flat, the top of a 3" diam. wood post, charred and flattened on two sides with pointed top believed to be GLO. Lying flat, the top of a 6" diam. wood post believed to be Vaughan's. Found vertical, the point of an 8" diam. wood post decayed at the bog surface believed to be Vaughan's. There is little or no evidence remaining of the GLO bearing trees, but this location agrees well with Vaughan's measurements to the North, West and across the entire width of Sec. 4. I accept the post point as the best remaining evidence of the original corner. At the corner point, I set a 2-1/2" diam., 60" long aluminum pipe with a 3-1/4" diam. Oneida Co. aluminum cap projecting 12" above the bog surface. I found or established accessories as shown below and set a white plastic sign post bearing Northeast, 1 ft. dist.

The coordinates shown were derived from two independent RTK observations of the corner point and are referenced to the WISCORS GNSS Network.

(c) (d) (e) Plan view of corner with ties to at least 4 witness monuments. If in disagreement with previously established corner, show the distances between the two corners and also indicate the ties to the disputed.

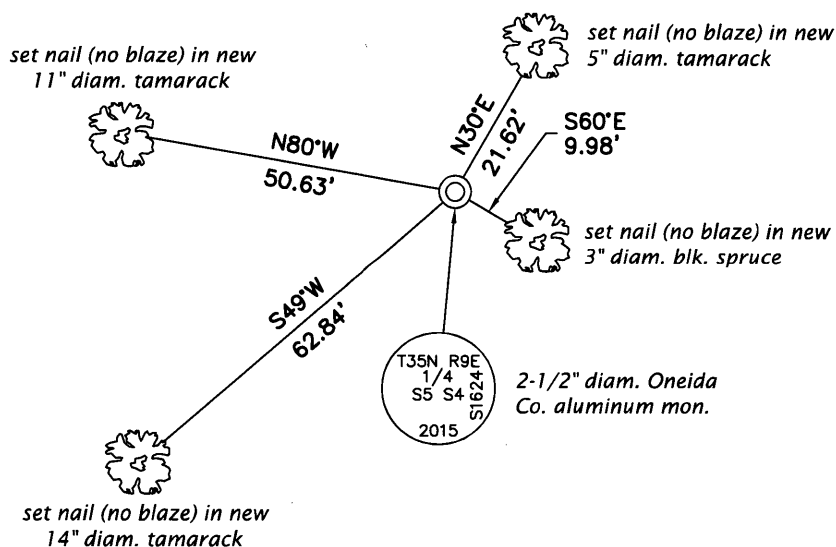

(i) I, Michael J. Romportl, Professional Land Surveyor No. S-1624, hereby certify that the corner location on this record was determined by me or under my direction and control and that this U.S. Public Land Survey Monument Record is correct and complete to the best of my knowledge and belief.

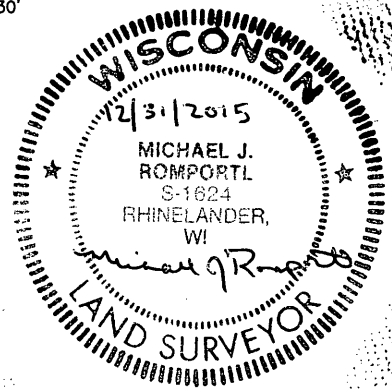

Michael J. Romportl
Signature

12/31/2015
Date