

CERTIFIED LAND CORNER RESTORATION

Copy from
Hanging Lake #49
Index No. 2-9
A-9
35-9

State of Wisconsin }
County of Lincoln } ss.

I, Raymond J. Willey, do hereby certify that on the 7th day of March, 1951, I found evidence of the 1/4 corner of Section 35, Township 34, Range 25, North, Range 25, Fourth Principal Meridian, as described hereon; and that from this evidence I established a new monument and accessories as described hereon to perpetuate the original location of this corner.

Resident witnesses:

History of original corner establishment:

Description of corner evidence found:

Found within the corner of Section 35, Township 34, Range 25, North, Range 25, Fourth Principal Meridian.

Description of monument and accessories I established to perpetuate the original location of this corner.

1 1/4 Section 35, Township 34, Range 25, North, Range 25, Fourth Principal Meridian

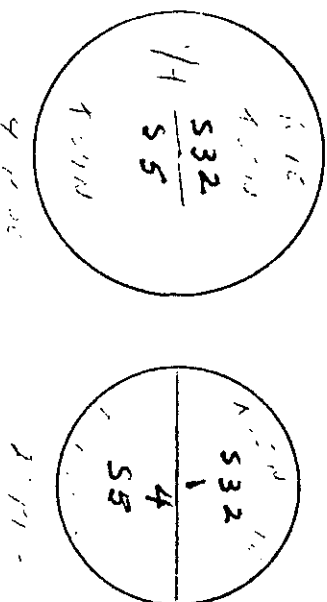

Dated at Lincoln, Wis., this 7th day of March, 1951

Signature: Raymond J. Willey Title: Gen. Surveyor Registration No. 0685
(County Surveyor, Registered Land Surveyor, or other duly authorized official)

Office of Register of Deeds, County of Lincoln, I hereby certify that the within instrument was filed in this office for record on the 7th day of March, 1951 at 10 o'clock A.M.

(Register of Deeds)

By: Raymond J. Willey Deputy

○ = Corner monument restored.

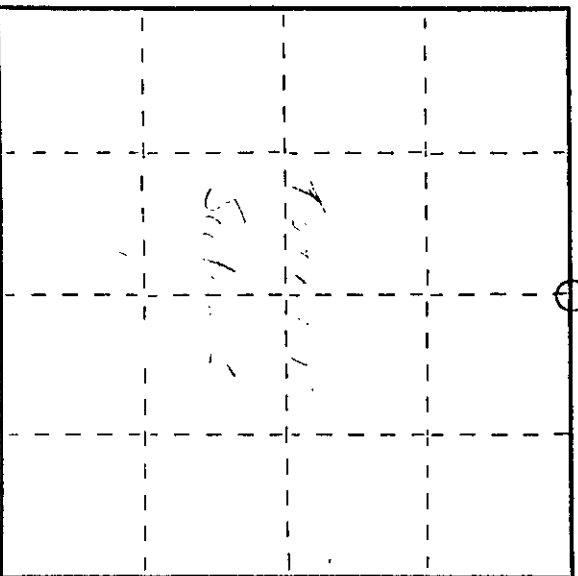

U. S. PUBLIC LAND SURVEY MONUMENT RECORD

Note: This form is intended and designed to fulfill all requirements of Wisconsin Administrative Code, Chapter A-E 7.08 U.S. Public Land Survey Monument Record (3) (a) (b) (c) (d) (e) (f) (g) (h) (i). An additional sheet may be added if necessary to conform with said requirements.

(a) CORNER LOCATION: Plane Coordinates
 1/4 Corner of Secs. 5 & 32 X:
 Township 34 & 35 North Y:
 Range 9 East of the 4th P.M. Datum:
 Town of Parrish County of Langlade

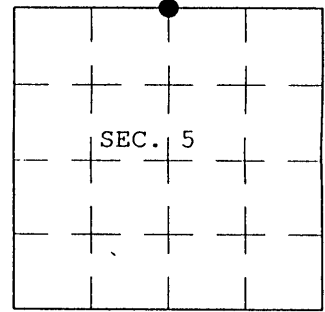

(b) HISTORY OF ORIGINAL CORNER ESTABLISHMENT

Original Surveyor: Hiram C. Fellows Original Accessories:
 Date of Survey: Commenced July, 1859 Birch 10" N.5°W., 21 lks.
 Completed July, 1859 Sugar 12" S.12°E., 23 lks.

(b) (f) (g) (h) Description of monument found at this corner and if it was accepted, state all evidence (material, testimonial, occupational, plats, records, other monuments) used as a basis for accepting. If not accepted or if nothing was found, state evidence used as basis for establishing location. If re-established through lost corner proportionate methods, indicate all monuments, distances and directions used to establish. Indicate type of monument and sign post found or set.

May, 1936: T.H. Kilroe determines the West three miles of the line common to Townships 34 and 35 North, Range 9 East to be lost. He re-establishes the corners on this line by running a straight line between controlling corners. "38.59 chs. set 1/4 cor. brass cap, Birch 13" S.31-1/2°W., 55.4"

December, 1937: H.C. Hall determines the West three miles of the line common to Townships 34 and 35 North, Range 9 East to be lost. He re-establishes the corners on this line by running a rhumb (curved) line between controlling corners. "1/4 stake official corner BTs: Y.Birch 12" N.24°W., .35; Y.Birch 12" S.47°E., .23; Maple 12" S.34°W., 50"

March 7, 1981: Raymond Hallisy prepares a U.S. Public Land Survey Monument Record and accepts the Kilroe monument with no indication that he recovered Hall's notes.

January 2, 2004: I found and accepted Hall's monument, a 2-1/2 ins. diam. iron post, projecting 34 ins. above the ground with brass cap mkd. as shown below. Hall's method is accepted practice in re-establishing lost corners of the U.S. Public Land Survey System. The corner is witnessed by Hall's stump hole, bears S.49°E., 12-1/2 ft. dist. and Hall's Maple stump, 24 ins. diam., bears S.37°W., 33-1/2 ft. dist. I established accessories as shown below and set a plastic sign post bearing Southwest, 1 ft. dist.

(c) (d) (e) Plan view of corner with ties to at least 4 witness monuments. If in disagreement with previously established corner, show the distances between the two corners and also indicate the ties to the disputed.

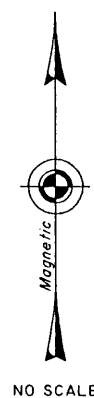
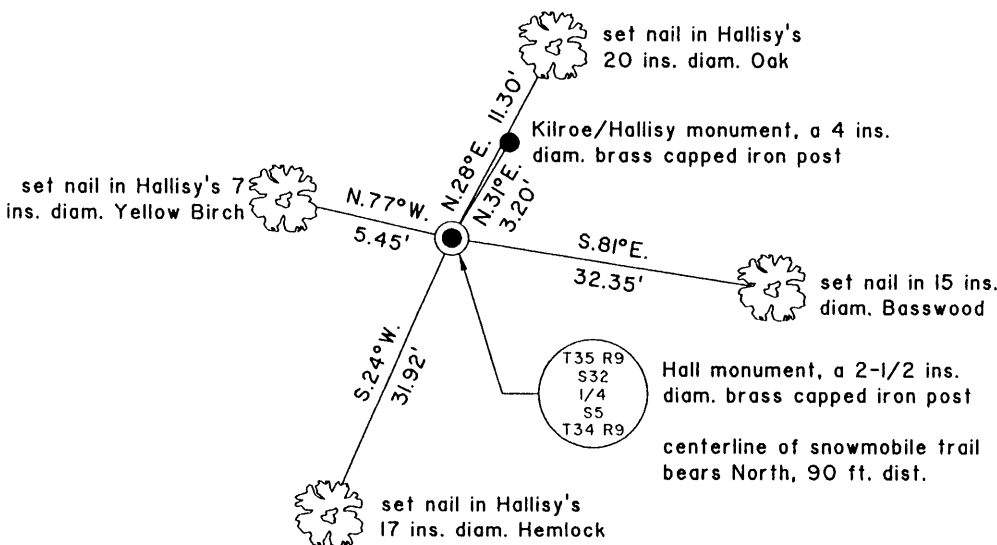

*Copies from
 Langlade County
 SEE Survey Map
 B-5548*

(i) I, Jeffrey W. Austin, Registered Land Surveyor No. S-1885, hereby certify upon honor that the corner location on this record was determined by me or under my direction and control and that this U.S. Public Land Survey Monument Record is correct and complete to the best of my knowledge and belief

[Handwritten Signature]

21 FEB 2004

Signature

Date



3509320020
 INDEX NO. 2-4