

CERTIFIED LAND CORNER RESTORATION

Index No. **E-18**

State of Wisconsin

County of Oneida

ss.

I Phillip T. Hansen, do hereby certify that on the 28th day of June, 1978, I found evidence of the W 1/16 corner of Section 2 & 11

Township 35 North, Range 10 East, Fourth Principal Meridian,

as described hereon; and that from this evidence I established a new monument and accessories as described hereon to perpetuate the original location of this corner.

Resident witnesses:

Jm Claflin

Herb Wagoner

John Masbaum

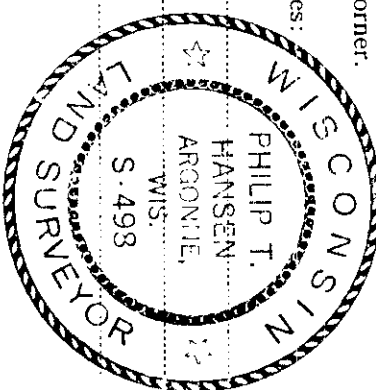

T35N R10E

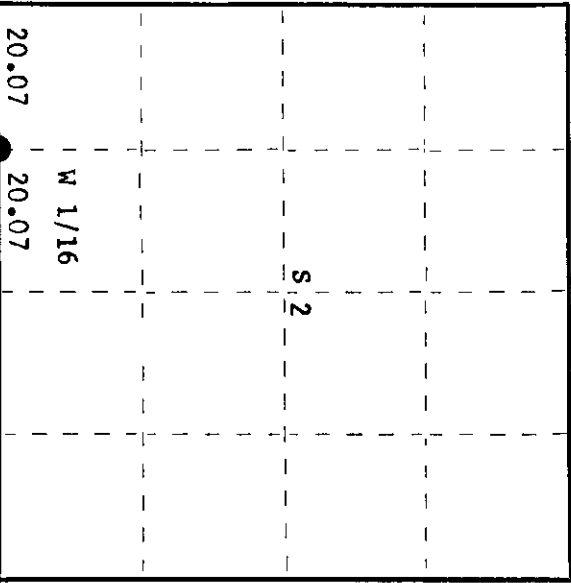

○ = Corner monument restored.

History of original corner establishment:

Corner established by N. Loftus, Ripco Surveyor, in 1960. Ran random line west from S 1/4 Section 2 bearing 263° magnetic, 120.825 chains to close out on section corner 3, 4, 9 & 10. Set corner 2, 3, 10 & 11 by double proportion at 40.14 chains west. Corrected bearing S 88° 39' W. Set W 1/16 at 20.07 chains. Marked NBR's - cedar 9" S44°E, 71 links; maple 9" N57°E, 48½ links.

Description of corner evidence found:

Recovered Ripco's 3/4" iron pipe with 2" square brass cap, stamped:
 Recovered cedar 9" (14") S44°E (S52°E), 71 links (70 links)
 maple 9" (12") S57°E, 48.5 links (49.3 links), scribed
 W 1/16 S11 BT.
 Monument recovered in excellent condition.

Description of monument and accessories I established to perpetuate the original location of this corner.

Monument projects 2" above ground.
 Marked NBR - white spruce 7" S56°W, 26.3 links, scribed 1/16 BT.

Dated at Rhineland, Wis., this 10th day of July, 1978

Signature: Phillip T. Hansen, Title: Registered Land Surveyor, Registration No. S-498
 (County Surveyor, Registered Land Surveyor, or other duly authorized official)

Office of Register of Deeds, County of Oneida, I hereby certify that the within instrument was filed in this office for record on the 21st day of August, 1978 at 1:00 o'clock P. M.

Doris Verage Kuehn
 (Register of Deeds)

By: _____ Deputy

3510020030