

CERTIFIED LAND CORNER RESTORATION

Index No. **B-21**

State of Wisconsin }
County of Oneida } ss.

I Phillip T. Hansen, do hereby certify that on the 21st day of May, 1976, I found evidence of the N 1/16 corner of section 1 & 2 Township 10 S, Range 35 N, Fourth Principal Meridian, as described hereon; and that from this evidence I established a new monument and accessories as described hereon to perpetuate the original location of this corner.

Resident witnesses:

Glen Barker

Jim Claffin

Herb Hagoner

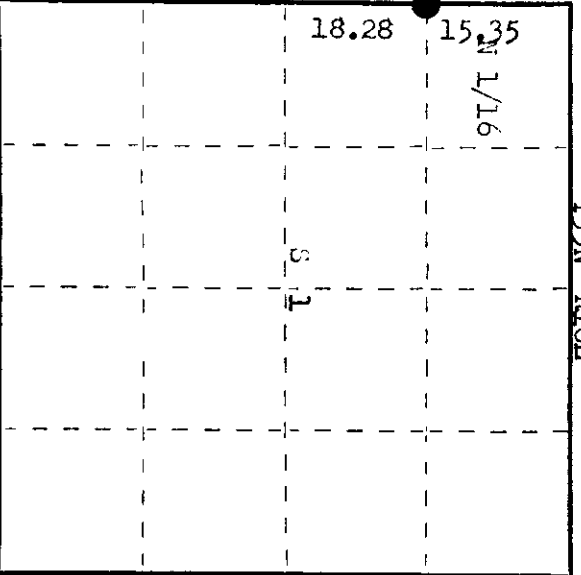
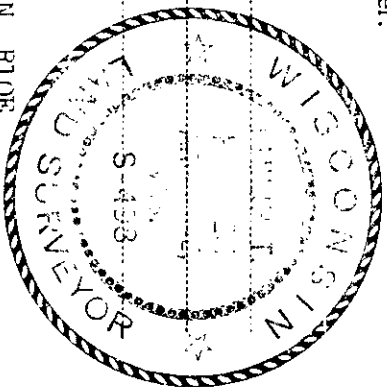

○ = Corner monument restored.

History of original corner establishment:

Original Corner established by B.F. Dorr, County Surveyor, in 1896.

H.C. Lawrence, Registered Land Surveyor, established the Corner in 1954 at its proportional distance between original 1/4 post and the original section corner, determined by B.F. Dorr in 1896. Marked NBT - S. Maple 17" N 46° W 32 1/2 lks
S. Maple 14" S 71° E 34 1/2 lks
Post sets 15.35 chains south of Range Line.

Description of corner evidence found:

Recovered 4" cedar post, squared and scribed N 1/16 S1, N 1/16 S2 in poor condition.

Recovered Maple 17" (20") N 46° W 32.5 lks, scribed S2 BT.
Maple 14" (18") S 71° E 34.5 lks, scribed N 1/16.

Description of monument and accessories I established to perpetuate the original location of this corner. Replaced wood post with 1 1/2" iron pipe with 2" brass cap stamped. Pipe projects 18" above ground. Monument and BTs painted blue. No additional accessories established.

S498
T35N R10E
N 1/16 S1
OPT-1976

Dated at Rhinelander, Wis., this 5th day of August, 1976.

Signature: *Phillip T. Hansen* Title: Registered Land Surveyor Registration No. S-498
County Surveyor, Registered Land Surveyor, or other duly authorized official

Office of Register of Deeds, County of Oneida. I hereby certify that the within instrument was filed in this office for record on the 21st day of September, 1976 at 1:00 o'clock P.M.

Dorcas H. Hage (Register of Deeds) *Yuehn*

By: Deputy

35/0023000