

CERTIFIED LAND CORNER RESTORATION

Index No. E-14

State of Wisconsin } ss.
 County of Oneida

I, Phillip T. Hansen, do hereby certify that on the 15th day of July, 19 77, I found evidence of the W 1/16 corner of Section 3 Township 35, North, Range 10 East, Fourth Principal Meridian, as described hereon; and that from this evidence I established a new monument and accessories as described hereon to perpetuate the original location of this corner.

Resident witnesses:

Jim Clafflin
Herb Wagoner

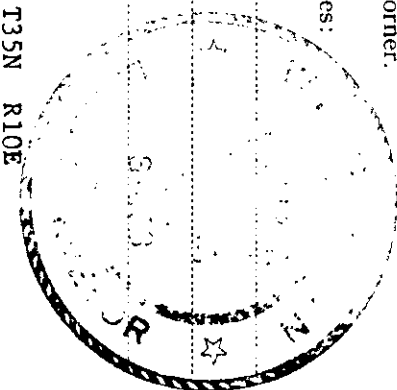

T35N R10E

History of original corner establishment:
 Corner established by N. Loftus, Ripco surveyor, in 1960. Ran line west from section corners 2, 3, 10 and 11, which was set by double proportion. Corrected bearing N 88° 39' E. Set west 1/16 20.17 chains intermediate, between 1/4 corner 3 and 10 and section corner. Marked NBT's cedar 10" N42°E 35-1/2 links; cedar 9" S56°W 14 links.

Description of corner evidence found:

Recovered 3/4" iron pipe with 2" square brass cap in good condition.
 Recovered OBT's - cedar 10" N42°E 35.5 links, scribed W 1/16 S3 BT.
 cedar 9" S56°W 14.0 links, scribed W 1/16 S10 BT.
 Monument projects 8", cap stamped:

T35N R10E
 W 1/16 S+3
 RIPCO

Description of monument and accessories I established to perpetuate the original location of this corner.
 Monument left in place as recovered.
 Set a 2" squared cedar stake beside monument.

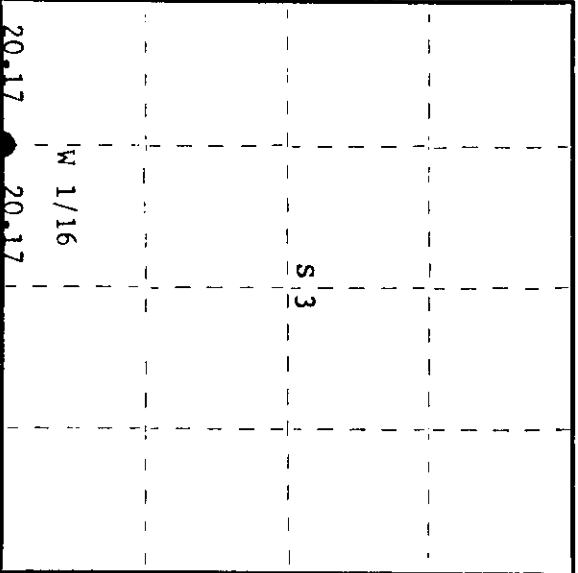

○ = Corner monument restored.

Dated at Rhineland, Wis., this 11th day of February, 19 80.

Signature Phillip T. Hansen Title Registered Land Surveyor Registration No. S-498
 (County Surveyor, Registered Land Surveyor, or other duly authorized official)

Office of Register of Deeds, County of Oneida 10th day of March, 19 80
 Instrument was filed in this office for record on the 9th day of March, 19 80
 at 9:10 o'clock A.M.

Doris Lenage Fuchs
 (Register of Deeds)

By: _____ Deputy

3510030030

State of Wisconsin

County of Oneida } ss.

I Philpp T. Hansen, do hereby certify that on the 10th day of November, 1978, I found evidence of the W 1/16 corner of Section 3 and 10 Township 35, North, Range 10 East, Fourth Principal Meridian, as described hereon; and that from this evidence I established a new monument and accessories as described hereon to perpetuate the original location of this corner.

Resident witnesses:

Jim Clafflin

Herb Wagoner

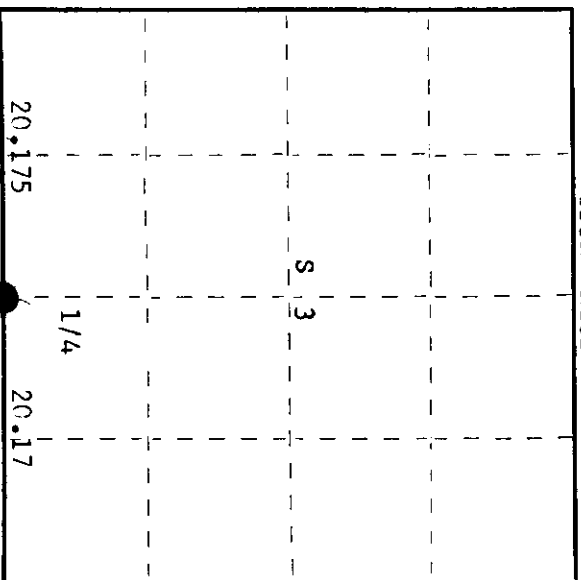
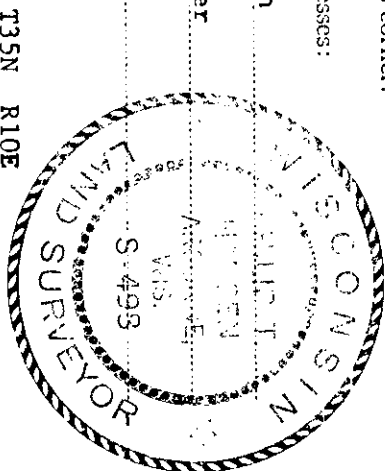

○ = Corner monument restored.

History of original corner establishment:

Corner established by N. Loftus, and H.C. Lawrence, Registered Land Surveyor, in 1960. Ran traverse from S 1/4 section 2 - bearing 268° magnetic, 120.82½ chains to close out on section corner 3, 4, 9 and 10. Set W 1/16 at 100.65 chains.

Marked ~~NBF's~~ -
Cedar 10" N42°E 35½ links
Cedar 9" S56°W 14 links

Description of corner evidence found:

Recovered Ripco's 3/4" iron pipe with 2" square brass cap projecting 8" above ground. Cap stamped:

Monument recovered in good condition.

Recovered CBF's -
Cedar 10" N42°E 35.5 links, scribed W 1/16 S3 BT.
Cedar 9" S55°W 14.0 links, scribed W 1/16 S10 BT.

T35N R10E
S+3
S-10
RIPCO

Description of monument and accessories I established to perpetuate the original location of this corner. Monument was left in place as recovered. Set a 2" square cedar post beside it for identification. No additional accessories established.

Dated at Rhineclander, Wis., this 4th day of January, 1979

Signature Phillip T. Hansen Title Registered Land Surveyor Registration No. S-498
(County Surveyor, Registered Land Surveyor, or other duly authorized official)

Office of Registrar of Deeds, County of Oneida
Instrument was filed in this office for record on the 25th day of January, 1979
at 1:15 o'clock P. M.

Debra Neugebauer
(Registrar of Deeds)

By: _____ Deputy

3510030030