

CERTIFIED LAND CORNER RESTORATION

Index No. D-17

State of Wisconsin }
 County of Oneida } ss.

I Phillip T. Hansen, do hereby certify that on the 6th day of September, 19 78, I found evidence of the S 1/16 corner of Sections 2 and 3 Township 35, North, Range 10 East, Fourth Principal Meridian, as described hereon; and that from this evidence I established a new monument and accessories as described hereon to perpetuate the original location of this corner.

Resident witnesses:
Jim Claflin
Herb Wagoner
John Masbaum

History of original corner establishment:
 Corner established by Ripco surveyors in 1961. Set by proportionate measurement. Distance from section corner 2-3, 10 and 11 to 1/4 corner between 2 and 3 was 39.905 chains. Set S 1/16 at 19.953 chains intermediate. Set iron pipe and marked NBT's - Sugar 6", N 38° E, 30½ links
 Hemlock 4", S 66° E, 29-3/4 links.

Description of corner evidence found:
 Recovered Ripco's 3/4" iron pipe with 2" square brass cap projecting 26" above ground. Cap stamped:
 Recovered OBT's - Hemlock 4" (7") S66°E, 29.75 links
 Sugar 6" (8") N38°E, 30.5 links, scribbling grown over.

S 1/16
 S3 + S2
 RIPCO

Description of monument and accessories I established to perpetuate the original location of this corner.
As monument was recovered in good condition, it was left in place as recovered.
 No additional accessories established.

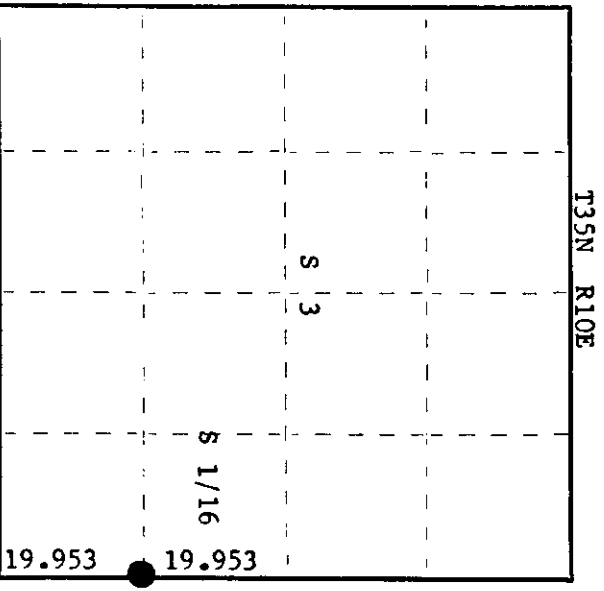

○ = Corner monument restored.

Dated at Rhineland, Wis., this 25th day of September, 19 78

Signature: Phillip T. Hansen Title: Registered Land Surveyor Registration No. S-498
 County Surveyor, Registered Land Surveyor, or other duly authorized official
 Office of Register of Deeds, County of Oneida
 Instrument was filed in this office for record on the 9th day of October, 19 78
 at 1:30 o'clock P. M.

Donna Marie Kuehn
 (Register of Deeds)

By: _____ Deputy

351003/000