

State of Wisconsin

County of Oneida } ss.

I Phillip T. Hansen, do hereby certify that on the 10th day of November, 1978, I found evidence of the S 1/16 corner of Section 3 and 4 Township 35 North, Range 10 East, Fourth Principal Meridian, as described hereon; and that from this evidence I established a new monument and accessories as described hereon to perpetuate the original location of this corner.

Resident witnesses:

Jim Clafflin

Herb Wagoner

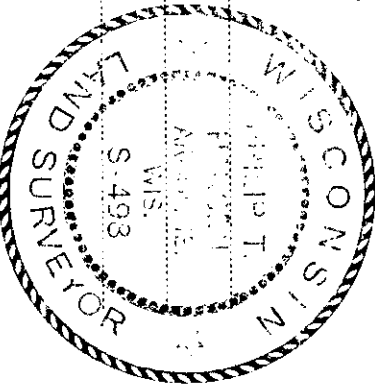

T35N R10E

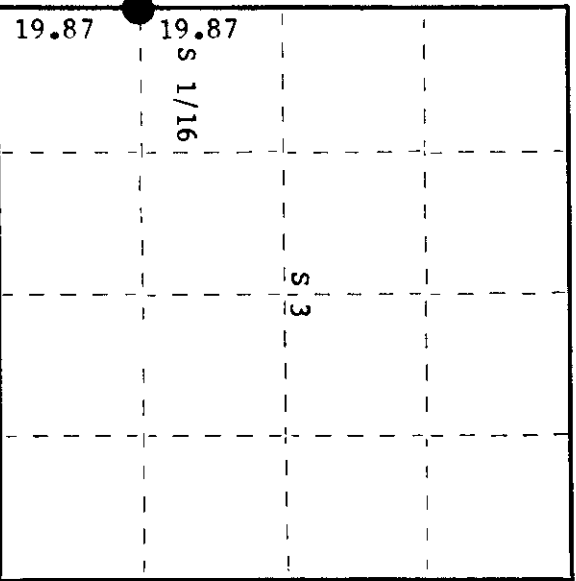

History of original corner establishment:

Corner established by Goddard and crew, Ripco surveyors, in 1961. Ran random line south from recovered 1/4 corner between section 3 and 4, bearing 180° 15' magnetic 39.74 chains to close out 9 links west of section corner. Set S 1/16 corner at 45 links east at 19.87 chains intermediate. Marked NBT's -

Birch 7" S74°E 44 links
Pine S13°W 27 links

Description of corner evidence found:

Recovered Ripco's 3/4" iron pipe with 2" diameter alloy cap in excellent condition. Monument projects 24" above ground. Cap stamped:

Recovered -
W. Birch 7" (8") S74°E 44.0 links (44.2 links), S4+S3
scribing grown over.
W. Pine 14" S13°W 27.0 links, S 1/16
scribed S 1/16 S4 BT. RIPCO

Description of monument and accessories I established to perpetuate the original location of this corner.
Monument left in place as recovered.
Placed a small rock cairn around base.
No additional accessories established.

Dated at Rhineland, Wis., this 4th day of January, 1979.

Signature Phillip T. Hansen Title Registered Land Surveyor Registration No. S-498
(County Surveyor, Registered Land Surveyor, or other duly authorized official)

Office of Register of Deeds, County of Oneida
Instrument was filed in this office for record on the 25th day of January, 1979
at 4:30 o'clock P. M.

Donna Leage Kuehn
(Register of Deeds)

By _____ Deputy

○ = Corner monument restored.