

State of Wisconsin

County of Oneida } ss.

I Philip T. Hansen, do hereby certify that on the 21st day of June, 19 77, I found evidence of the E 1/16 corner of Section 5 & 8 Township 35, North, Range 10 East, Fourth Principal Meridian, as described hereon; and that from this evidence I established a new monument and accessories as described hereon to perpetuate the original location of this corner.

Resident witnesses:

- Glen Barker
- Jim Clafflin
- Herb Wagoner

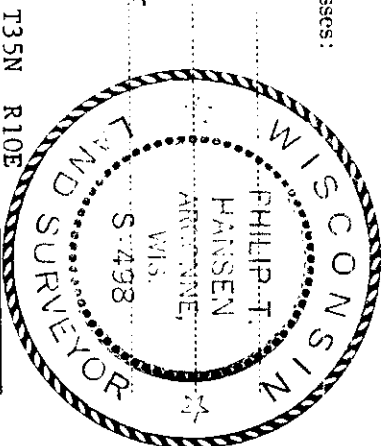

History of original corner establishment:  
 Corner established by N. Loftus, Ripco Surveyor, in 1957. From previously restored section corner 5, 6, 7 & 8, ran random line N86°E, 40.33 chains to close out 32½ links north of 1/4 corner. Corrected bearing N86° 28' E. Continued East 39.86 chains, closed out 1.69 chains north of Section Corner 4, 5, 8 & 9. Corrected bearing N 88° 37' E. Set E 1/16 at 19.93 chains intermediate. Set iron pipe and marked NBTs - Maple 8" S16°W, 7½ links. Maple 8" N73°W, 16 links.

Description of corner evidence found:

Recovered 1½" iron pipe with 2" brass cap, stamped: T35N R10E  
 Monument recovered in good condition, projects 2½' above ground. S15  
 Recovered OBTs - Maple 10" S16°W, 7.5 links, scribing grown over. E 1/16 S15  
 Maple 8" N73°W, 16 links, scribing grown over. RIPCO

Description of monument and accessories I established to perpetuate the original location of this corner.  
 No additional accessories established.  
 Built a large rock cairn around base.

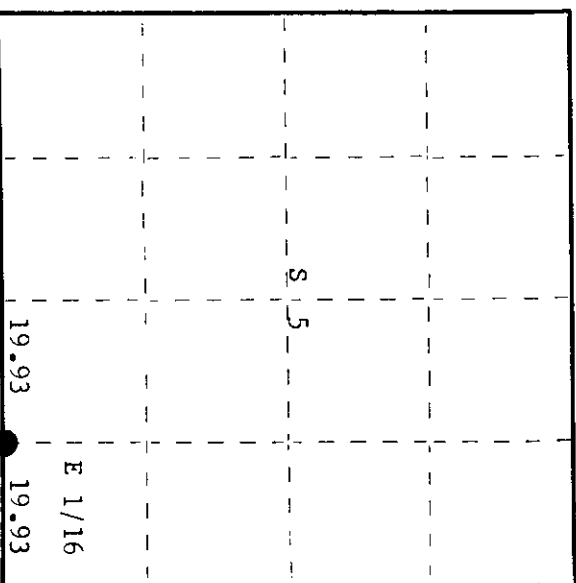

○ = Corner monument restored.

Dated at Rhineland, Wis. this 30th day of June, 19 77.

Signature Philip T. Hansen Title Registered Land Surveyor Registration No. S-498  
(County Surveyor, Registered Land Surveyor, or other duly authorized official)

Office of Register of Deeds, County of Oneida I hereby certify that the within instrument was filed in this office for record on the 8th day of July, 19 77 at 1:30 o'clock M.

Doris Savage Tuelke  
(Register of Deeds)

By Joseph M. Brown Deputy

3510050010