

State of Wisconsin

County of Oneida

} ss.

I Phillip T. Hansen, do hereby certify that on the 21st day of June, 1977, I found evidence of the SC 1/16 corner of Section 5 Township 35, North, Range 10 East, Fourth Principal Meridian,

as described hereon; and that from this evidence I established a new monument and accessories as described hereon to perpetuate the original location of this corner.

Resident witnesses:

Glen Barker

Jim Claflin

Herb Wagoner

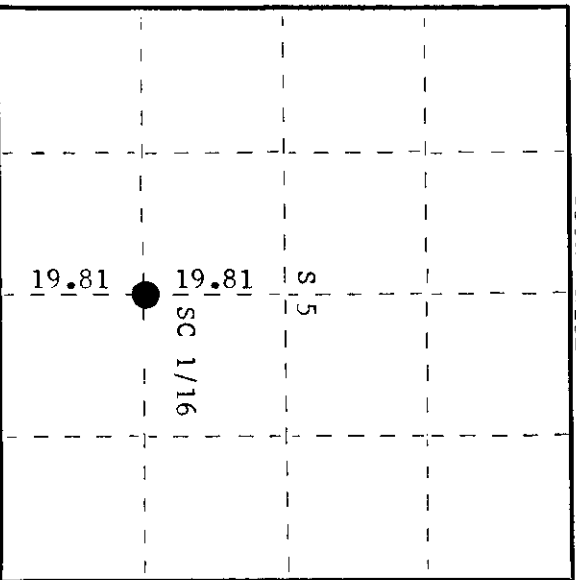
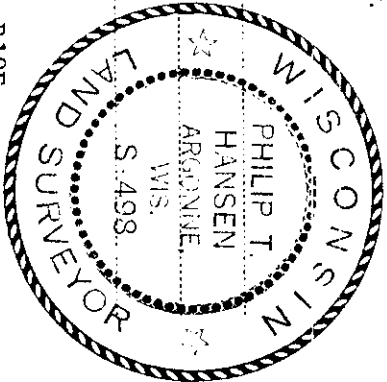

○ = Corner monument restored.

History of original corner establishment:

Corner established by N. Loftus, Ripco Surveyor, in 1957. Ran N-S and E-W 1/4 lines from previously established 1/4 corners to establish C 1/4 Corner. C 1/4 corner established was 39.62 chains N 3° 25' W of south 1/4 corner. Set SC 1/16 at 19.81 chains intermediate. Set iron pipe and marked NBTs - White Pine 14" S47°W, 87½ links
Red Maple 14" N38°E, 35 links

Description of corner evidence found:

Recovered 1½" iron pipe with 2" square brass cap stamped:
Monument recovered in good condition.
Recovered OBTs - White Pine 17" S77°W, 87.5 links, now a cut off stump.
Sugar 17" (18") N38°E (N32°E) 35 links.
Monument projects 24" above ground.

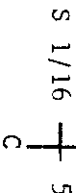

Description of monument and accessories I established to perpetuate the original location of this corner.
Monument left as recovered.

NBT - Maple 8" S78°W, 55.5 links, scribed 1/16 BT.

Dated at Rhineland, Wis., this 30th day of June, 1977.

Signature: Phillip T. Hansen Title: Registered Land Surveyor Registration No. S-498
(County Surveyor, Registered Land Surveyor, or other duly authorized official)

Office of Register of Deeds, County of Oneida
Instrument was filed in this office for record on the 8th day of July, 1977
at 1:30 o'clock M. I hereby certify that the within

David Wayne Kiehn
(Register of Deeds)

By: Joseph M. Boomer Deputy

3510051020