

CERTIFIED LAND CORNER RESTORATION

Index No. **C-9**

State of Wisconsin

County of Oneida } ss.

I Phillip T. Hansen, do hereby certify that on the 20th day of June, 19 77, I found evidence of the Quarter corner of Section 4 & 5 Township 35, North, Range 10 East, Fourth Principal Meridian, as described hereon; and that from this evidence I established a new monument and accessories as described hereon to perpetuate the original location of this corner.

Resident witnesses:

- Glen Barker
- Jim Claflin
- Herb Wagoner

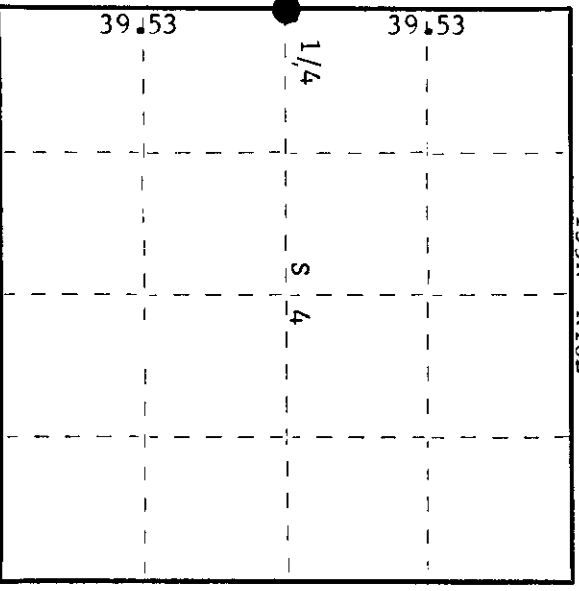
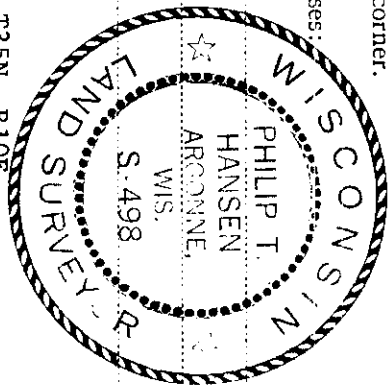

○ = Corner monument restored.

History of original corner establishment:

Original Corner established by James L. Nowlin, Deputy Surveyor, in 1865, from which Aspen 20" bears S72°W, 10 links and Birch 10" bears N73°E, 15 links. N. Loftus, Ripco Surveyor, searched for but unable to locate any corner in 1957. Ran random line south 1° 06' 30" East. Closed out 2.43½ chains west of Section Corner, Iron pipe with brass cap, 1/4 corner set at 39.53 chains south.

Description of corner evidence found:

- Recovered 2" iron pipe with 4" brass cap stamped: Monument recovered in good condition.
- Recovered OBTS - Hemlock 14" S42°W, 50 links, scribing visible. Maple 10" N20°E, 29.5 links, scribing visible.
- Monument projects 18" above ground.

1/4 S
S5 S4
+

RIPCO

Description of monument and accessories I established to perpetuate the original location of this corner. Monument left as recovered. Marked NBT - Maple 10" N56°W, 16.2 links, scribed 1/4 BT.

Dated at Rhineland, Wis., this 29th day of June, 19 77.

Signature Phillip T. Hansen Title Registered Land Surveyor Registration No. S-498
(County Surveyor, Registered Land Surveyor, or other duly authorized official)

Office of Registrar of Deeds, County of Oneida at 8:00 o'clock M. day of July, 19 77. I hereby certify that the within instrument was filed in this office for record on the 13th day of July, 19 77.

Terri Savage Kuehl
(Registrar of Deeds)

By Joseph M. Berman Deputy

U.S. PUBLIC LAND SURVEY MONUMENT RECORD

Note: This form is intended and designed to fulfill all requirements of Wisconsin Administrative Code, Chapter A-E 7.08 U.S. Public Land Survey Monument Record (3)(a-i).

(a) CORNER LOCATION
 1/4 Cor. of Secs. 4 & 5
 Township 35 North
 Range 10 East of the 4th P.M.
 Town of Enterprise & Schoepke
 County of Oneida

WISCORS - Oneida County
 N: 131,755.35 USft
 E: 303,536.98 USft
 Datum: NAD 83(2011)
 GNSS Method: Static - Direct
 GNSS Control: WISCORS VRS

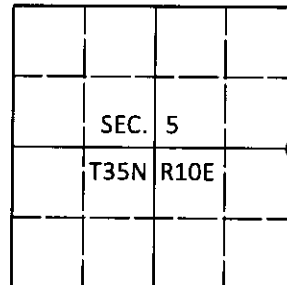

(b) HISTORY OF ORIGINAL CORNER ESTABLISHMENT

Original Surveyor: _____ Original Accessories: _____
 Date of Survey Commenced: _____ See previous USPLS Monument Record
 Completed: _____

(b)(f)(g)(h) Description of monument found at this corner and if it was accepted, state all evidence (material, testimonial, occupational, plats, records, other monuments) used as a basis for accepting. If not accepted or if nothing was found, state evidence used as basis for establishing location. If re-established through lost corner proportionate methods, indicate all monuments, distances and directions used to establish. Indicate type of monument and sign post found or set.

This is a perpetuation of a previous USPLS Monument Record by Philip T. Hansen, RLS dated June 29, 1977 and filed in the office of the Oneida County Register of Deeds. A complete history of the corner can be found on the previous monument record. I accept the previous location as a true and faithful perpetuation or reestablishment of the original corner location and further perpetuate it as follows.

August 21, 2018: I found and accepted the record monument, a 2-1/2" diam. iron pipe with a 4" sq. RIPCO brass plate projecting 18" above the ground surface. I found no evidence of the record bearing tree at N20°E. The record bearing trees at N56°W and S42°W are cut stumps. I found or established accessories as shown below. I found a white vinyl sign post bearing West, 1.0 ft.

The coordinate value shown has been verified by at least one of the following methods: 1) comparison to a previously GPS determined published value; 2) the value is the average of two or more GPS observations at a markedly different time; 3) one or more distances were measured back to the GPS observed corner from temporary GPS observed offset locations.

(c)(d)(e) Plan view of corner with ties to at least 4 witness monuments. If in disagreement with previously established corner, show the distances between the two corners and also indicate the ties to the disputed.

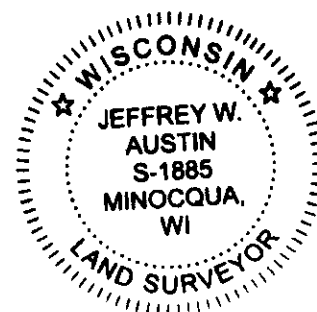
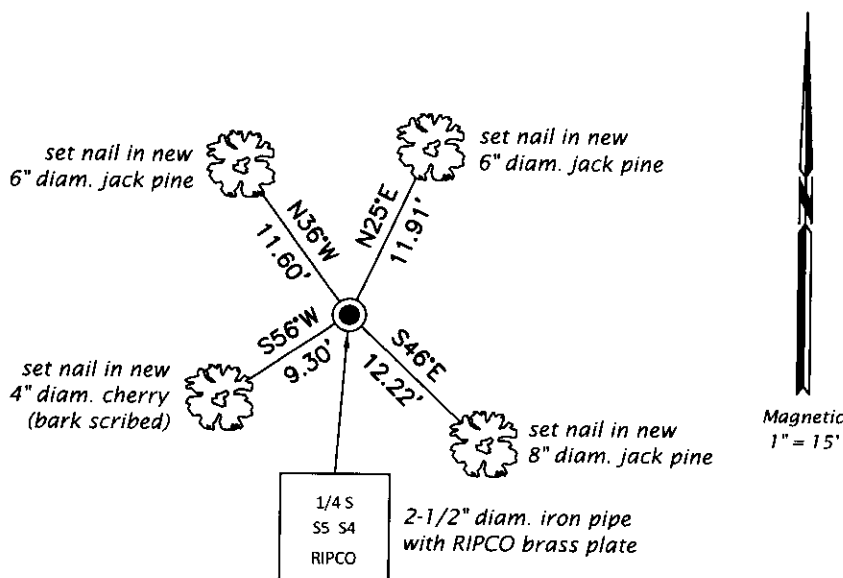

REGISTER OF DEEDS OFFICE
 ONEIDA COUNTY
 FILED

SEP 10 2018

KYLE J. FRANSON
 REGISTER OF DEEDS

(i) I, Jeffrey W. Austin, Professional Land Surveyor No. S-1885, hereby certify that the corner location on this record was determined by me or under my direction and control and that this U.S. Public Land Survey Monument Record is correct and complete to the best of my knowledge and belief.

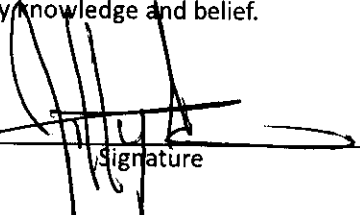
 _____
 Signature Date: SEP 5, 2018