

CERTIFIED LAND CORNER RESTORATION

Index No. D-4

State of Wisconsin } ss.
 County of Oneida }

History of original corner establishment:
 Corner established by Drivas and crew, Ripco surveyors, in 1962. From previously established C-S 1/16 ran S 88° 17' 55" east 40.57 chains to close out 2.2 links north of S 1/16 east line. Set SE 1/16 at 20.285 chains. Marked NBT - Black Spruce 8" S69°W 1.075 chains.

I, Phillip T. Hansen, do hereby certify that on the 20th day of December, 1977, I found evidence of the SE 1/16 corner of Section 6, Township 35 North, Range 10 East, Fourth Principal Meridian, as described hereon; and that from this evidence I established a new monument and accessories as described hereon to perpetuate the original location of this corner.

Description of corner evidence found:
 Recovered 3/4" iron pipe with alloy cap, stamped: S 6
 Monument projects 16" above ground. SE 1/16
 Monument recovered in good condition. RIPCO
 Recovered OBT - Black Spruce 8" S89°W 1.075 chains, not scribed.

Resident witnesses:

Glen Barker
 Jim Clafin
 Herb Wagoner

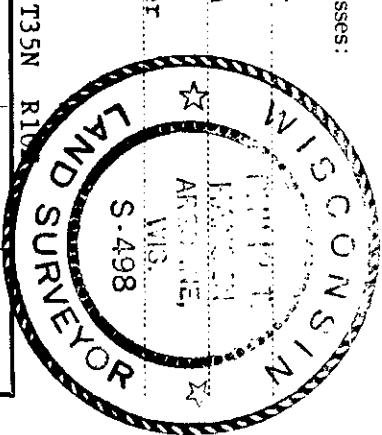

Description of monument and accessories I established to perpetuate the original location of this corner.
 Monument left in place as recovered.
 Marked NBT's - Cedar 14" N45°W 113 links
 Balsam 6" N83°W 139.3 links
 both scribed 1/16 BT.
 Corner sets in alders.

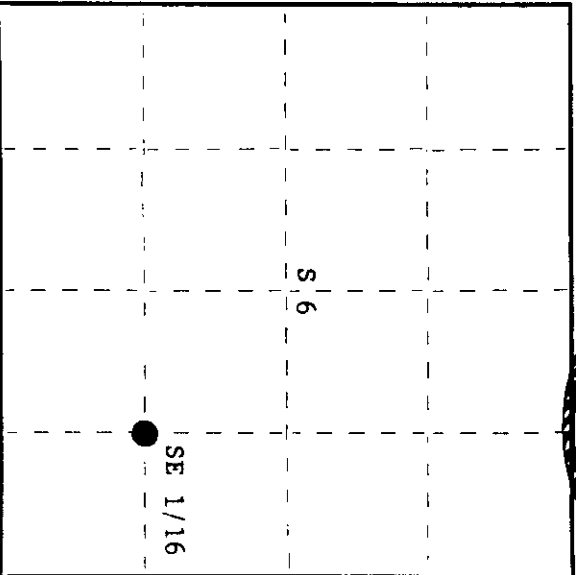

○ = Corner monument restored.

Dated at Rhinelander, Wis., this 14th day of January, 1980.

Signature: Phillip T. Hansen Title: Registered Land Surveyor Registration No. S-498
 (County Surveyor, Registered Land Surveyor, or other duly authorized official)

Office of Register of Deeds, County of Oneida, 11th day of February, 1980.
 at 2:15 o'clock P.M. I hereby certify that the within instrument was filed in this office for record on the 11th day of February, 1980.

Signature: Donna Savage Fuchs
 (Register of Deeds)

By: _____ Deputy

State of Wisconsin

County of Washington } ss.

I, Alvin H. Hering, do hereby certify that on the 22nd day of February, 1978, I found evidence of the original corner of the Section 16, Township North, North, Range Fourth Principal Meridian, as described hereon; and that from this evidence I established a new monument and accessories as described hereon to perpetuate the original location of this corner.

Resident witnesses:

John J. Hering

Alvin H. Hering

History of original corner establishment:

[Faint, illegible text describing the history of the original corner establishment.]

Description of corner evidence found:

[Faint, illegible text describing the corner evidence found.]

Description of monument and accessories I established to perpetuate the original location of this corner.

[Faint, illegible text describing the monument and accessories.]

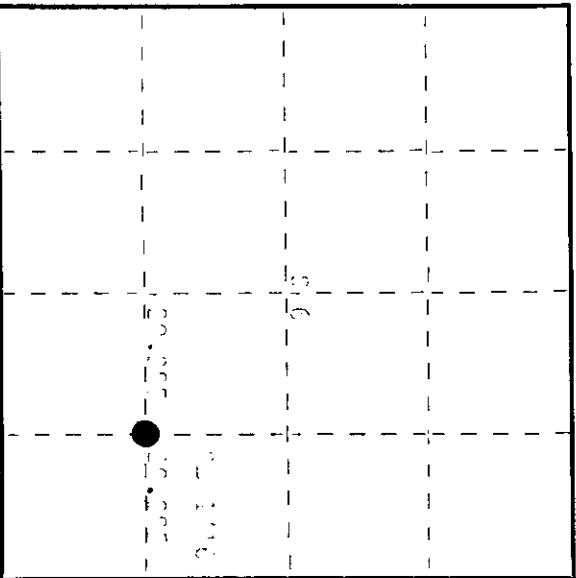

○ = Corner monument restored.

Dated at Washington, Wis., this 22nd day of February, 1978

Signature Alvin H. Hering Title Registered Land Surveyor Registration No. 30000
(County Surveyor, Registered Land Surveyor, or other duly authorized official)

Office of Register of Deeds, County of Washington I hereby certify that the within instrument was filed in this office for record on the 22nd day of February, 1978 at 2:00 o'clock P. M.

Alvin H. Hering (Register of Deeds)

By Alvin H. Hering Deputy

3510061010