

CERTIFIED LAND CORNER RESTORATION

Index No. U-2

State of Wisconsin

County of Oneida } ss.

I Phillip T. Hansen, do hereby certify that on the 21st day of March, 1978, I found evidence of the W 1/16 corner of Section 7 and 18

Township 35, North, Range 10 East, Fourth Principal Meridian,

as described hereon; and that from this evidence I established a new monument and accessories as described hereon to perpetuate the original location of this corner.

Resident witnesses:

Glen Barker

Jim Clafflin

Herb Wagoner

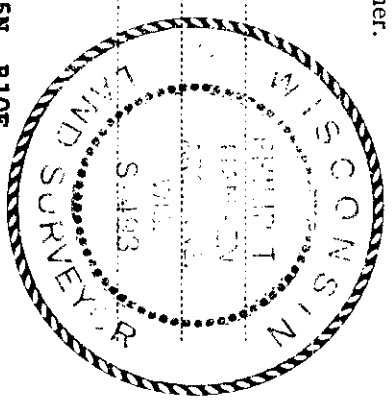

History of original corner establishment:
 Corner established by H.C. Lawrence, Registered Land Surveyor, in 1946. Ran random line east S 85° 30' E and at 43.14 chains intersected N-S 1/4 line at point 3.87 chains north of an old 1/4 post which he had restored. Corrected bearing S 82° 30' E. Ran new random line at corrected bearing and set W 1/16 corner by proportionate measurement on true line. Set post at 22.47 chains. Marked NBT's - Aspen 9" S40°E, 25 links; Aspen 12" N 5° W, 24 links.

Description of corner evidence found:
 Recovered 4" tamarack post, squared and scribed W 1/16 S7, W 1/16 S18, standing with rock cairn around base.
 Recovered OBT's - Aspen 12" N5°W, 24 links, scribed BT, now dead.
 Aspen 9" S40°E, 25 links, now down and rotted.

Description of monument and accessories I established to perpetuate the original location of this corner.

Replaced 4" tamarack post with 1 1/2" iron pipe with 2" brass cap, stamped:
 Monument projects 18" above ground. S498
 Replaced rock cairn around base. T35N R10E
 Marked NBT's - Maple 6" N89°W, 55.4 links W 1/16 S+7
 Maple 6" S62°E, 13.7 links, scribed 1/16 BT. CPI-1978

Dated at Rhineland, Wis., this 5th day of April, 1978

Signature Phillip T. Hansen Title Registered Land Surveyor Registration No. S-498
 County Surveyor, Registered Land Surveyor, or other duly authorized official

Office of Register of Deeds, County of Oneida
 Instrument was filed in this office for record on the 17th day of April, 1978
 at 5:50 o'clock P. M.

Dorcas Lange Kuehn
 (Register of Deeds)

By: _____ Deputy

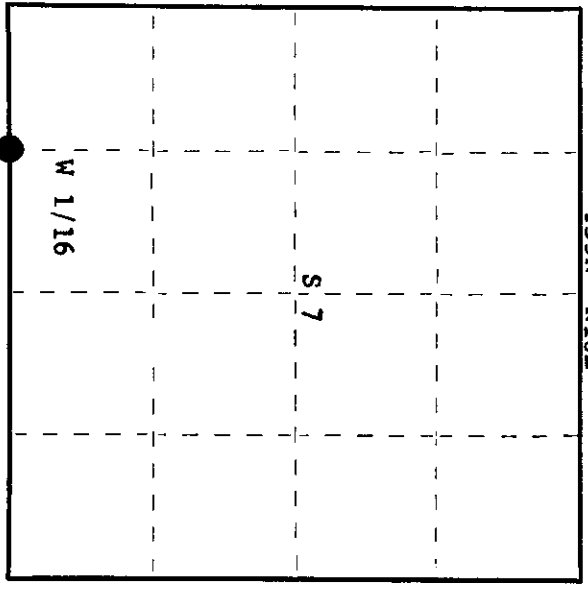

3510070030