

CERTIFIED LAND CORNER RESTORATION

Index No. F-6

State of Wisconsin }
County of Oneida } ss.

I, Philip T. Hansen, do hereby certify that on the 12th day of October, 1978, I found evidence of the NW 1/16 corner of Section 8 Township 35, North, Range 10 East, Fourth Principal Meridian, as described hereon; and that from this evidence I established a new monument and accessories as described hereon to perpetuate the original location of this corner.

Resident witnesses:

Jim Claflin

Herb Wagoner

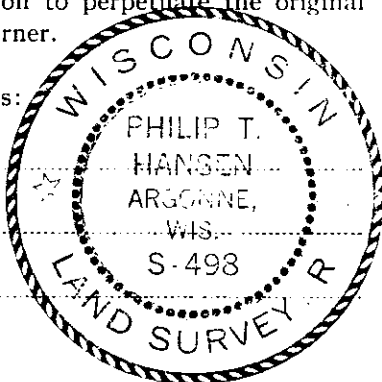

FORM 985 M. C. MILLER CO., MILWAUKEE

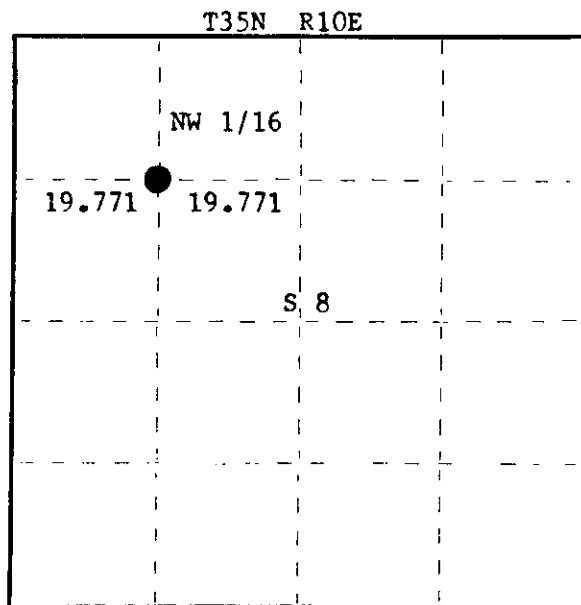

○ = Corner monument restored.

History of original corner establishment:

Corner established by N. Loftus, Ripco surveyor, in 1962. Ran random line west, bearing S 88° 45' 11" W, 39.543 chains to close out 3 links south of N 1/16 west line. Set NW 1/16 at 19.771 chains, 1½ links north. Marked NBT's - Spruce 5" N5°E 25 links
Maple 13" S1°W 34 links

Description of corner evidence found:

Recovered Ripco's 3/4" iron pipe with 2" diameter alloy cap, not stamped. Monument was leaning over. Recovered OBT - Maple 13" S1°W 34.0 links, now a dead 20' snag. Spruce 5" N5°E 25.0 links, now a cut off stump. Monument projects 1½' above ground.

Description of monument and accessories I established to perpetuate the original location of this corner.

Reset monument to correct ties to BT's - now projects 1½' above ground, stamped cap: Marked NBT's -
Maple 8" S10°E 57.7 links
Maple 6" N8°W 100.0 links
both scribed 1/16 BT

T35N R10E
NW 1/16 S+8

Dated at Rhineland, Wis., this 23rd day of October, 1978

Signature Philip T. Hansen Title Registered Land Surveyor Registration No. S-498
(County Surveyor, Registered Land Surveyor, or other duly authorized official)

Office of Register of Deeds, County of Oneida, I hereby certify that the within instrument was filed in this office for record on the 6th day of November, 1978 at 10:00 o'clock A M.

Doris Terage Kuehn
(Register of Deeds)

By..... Deputy

3510083030