

CERTIFIED LAND CORNER RESTORATION

Index No. J-13

State of Wisconsin

County of Oneida } ss.

I, Philip F. Hansen, do hereby certify that on the 7th day of April, 1976, I found evidence of the Section corner of Sec. 9-10-15, 16 Township 35, North, Range 10 East, Fourth Principal Meridian, as described hereon; and that from this evidence I established a new monument and accessories as described hereon to perpetuate the original location of this corner.

Resident witnesses:

Glen Barker
Jim Clafin
Herb Wagoner

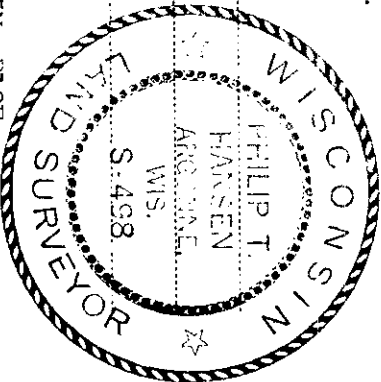

T35N R10E

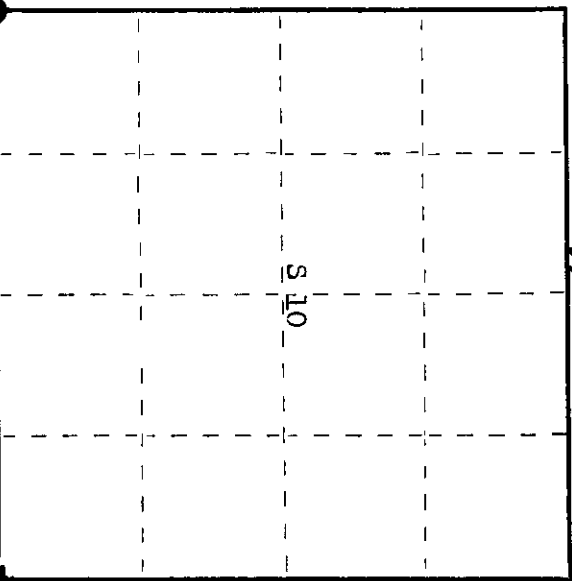

○ = Corner monument restored.

History of original corner establishment: Original corner established by James L. Nowlin, Deputy Surveyor, in 1865, from which Birch 15" bears N 52° E 25 lks and Spruce 12" bears N 19° W 22 lks.

Corner set by double proportion by Vaughan, County Surveyor, in 1899. NBTs - W. Birch 14" N 40° W 22 lks, Hemlock 9" S 65° W 36 lks. Set iron pipe.

Corner recovered by H.C. Lawrence, Registered Land Surveyor, in 1959. Set new cedar post and marked NBTs - Cedar 10" N 18° W 46 lks, Cedar 9" S 75° W 54 lks.

Description of corner evidence found: Recovered 6" cedar post, squared and scribed S9, S10, S15, S16. Also recovered a 1 1/2" iron pipe beside it. A rock cairn had been built around them.

Recovered OBTs - Cedar 10" (11") S 75° W (S 78° W) 54 lks, scribed S16 NBT.
Cedar 9" N 18° W 46 lks, now blown down, found S9 scribing.

Corner sets at the North end of an old road which turns and continues East.

Description of monument and accessories I established to perpetuate the original location of this corner.
Replaced cedar post and iron pipe with 2 1/2" iron pipe with brass cap stamped.

Pipe projects 18" above ground.
Replaced rock cairn around base of monument. Placed scribed cedar post on rock cairn.

NBTs - Black Spruce 8" N 66° W 22.1 lks, scribed S9 BT.
Cedar 6" N 40° W 29.5 lks, scribed S9 BT.
Monument and BTs painted blue.

S498
T35N R10E
Sec. 9 | 10
16 | 15
CPI - 1976

Dated at Oneida, Wis., this 6th day of July, 1976.

Signature: Philip F. Hansen Title Registered Land Surveyor Registration No. S-498
(County Surveyor, Registered Land Surveyor, or other duly authorized official)

Office of Register of Deeds, County of Oneida
Instrument was filed in this office for record on the 23rd day of July, 1976
at 100 o'clock M. I hereby certify that the within

Signature: Doris Heritage Kuehn
(Register of Deeds)

By: _____ Deputy

3510090000

U.S. PUBLIC LAND SURVEY MONUMENT RECORD

Note: This form is intended and designed to fulfill all requirements of Wisconsin Administrative Code, Chapter A-E 7.08 U.S. Public Land Survey Monument Record (3) (a) (b) (c) (d) (e) (f) (g) (h) (i). An additional sheet may be added if necessary to conform with said requirements.

(a) Corner location: Township 35 North

Range 10 East/West

Town/City/Village E. ENTERPRISE W. SCHOEPEKE

County ONEIDA

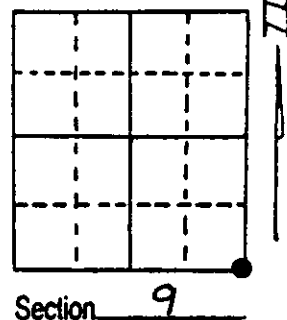
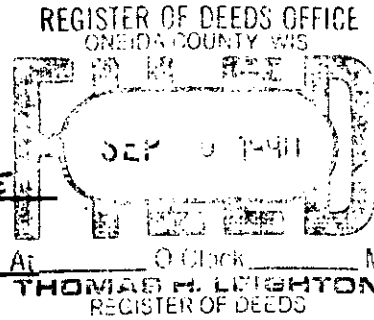

(b) (f) (g) (h) Description of monument found at this corner and if it was accepted, state all evidence (material, testimonial, occupational, plats, records, other monuments) used as a basis for accepting. If not accepted or if nothing was found, state evidence used as basis for establishing location. If reestablished through lost corner proportionate methods, indicate all monuments, distances and directions used to establish. Indicate type of monument found or set and sign post.

1865, JAMES NOWLIN ESTABLISHED ORIGINAL CORNER

1899, VAUGHAN USED CORNER

1932, RAY MARSHALL DROVE IRON PIPE

1990, I FOUND 2" BRASS CAP MONUMENT PUT IN BY CONSOLIDATED PAPER CO. IN 1976. SET POST NEXT TO MONUMENT. MARKED NEW BEARING TREES

(c) (d) (e) Plan view of corner with ties to at least 4 witness monuments. If in disagreement with previously established corner, show the distances between the two corners and also indicate the ties to the disputed corner.

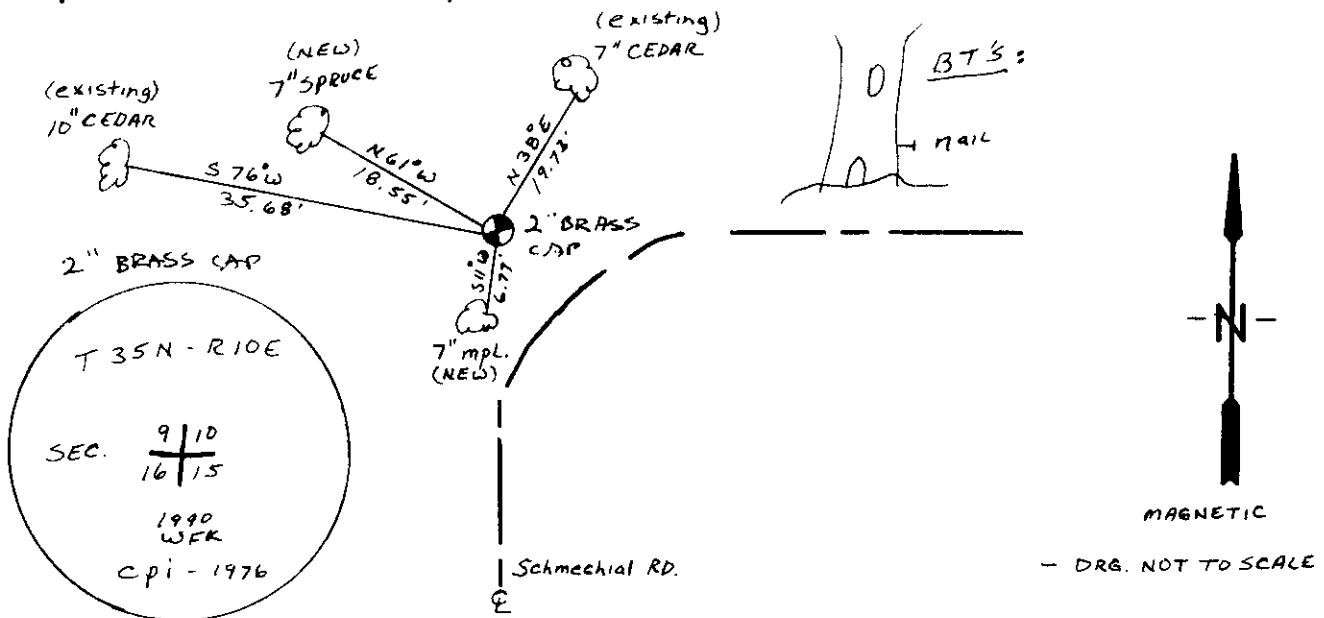

(i) I, WILLIAM F. KELLY
 (type or print name) certify that the corner location on this record was determined by me or under my direction and control and that this U.S. Public Land Survey Monument Record is correct and complete to the best of my knowledge and belief.

William F. Kelly 8-28-80
 Signature Date



Index No. J-13

Stamp
 3510090000