

CERTIFIED LAND CORNER RESTORATION

Index No. 7-16

State of Wisconsin

County of Oneida

ss.

I Philip T. Hansen, do hereby certify that on the 9th day of October, 1978, I found evidence of the NE 1/16 corner of Section 10 Township 35 North, Range 10 East, Fourth Principal Meridian, as described hereon; and that from this evidence I established a new monument and accessories as described hereon to perpetuate the original location of this corner.

Resident witnesses:

Jim Claffin

Herb Wagoner

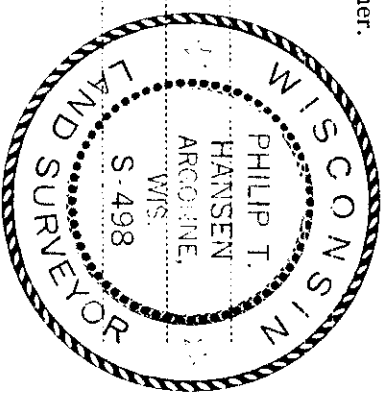

T35N R10E

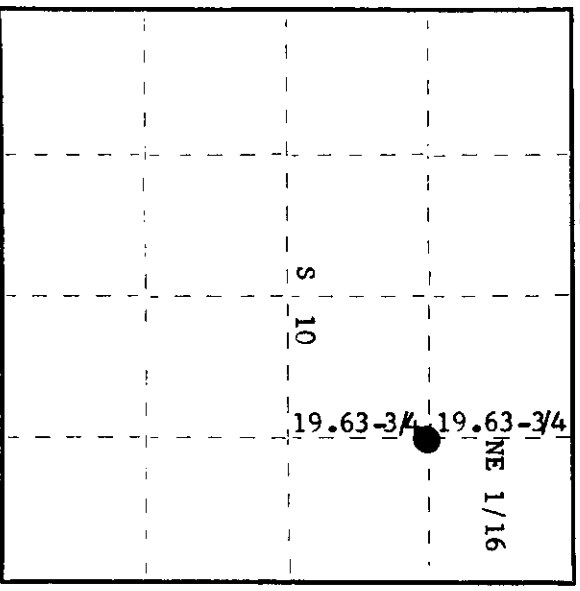

○ = Corner monument restored.

History of original corner establishment:

Corner established by N. Loftus, Ripco surveyor, in 1961. Ran random line south (bearing 176° 24' mag.) from E 1/16, north line section 10, 39.275 chains to close out 52½ links east of EC 1/16. Set NE 1/16 at 19.63-3/4 chains at 26.5 links west. Marked NBT's -

- W.Spruce 7" S31°E 31½ links
- R.Pine 4" N52°E 35 links

Description of corner evidence found:

Recovered 3/4" iron pipe with 2" square brass cap in good condition. Monument projects 24" above ground. Cap stamped:

Recovered OBT's -  
W. Spruce 7" (12") S31°E, 31.5 links,  
scribing grown over  
Red Pine 4" (7") N52°E, 35.0 links,  
scribing visible.

T35N R10E  
NE 1/16 S10  
RIPCO

Description of monument and accessories I established to perpetuate the original location of this corner. Monument left in place as recovered. No additional accessories established.

Dated at Rhinelander, Wis., this 18th day of October, 1978

Signature Philip T. Hansen, Title Registered Land Surveyor, Registration No. S-498  
(County Surveyor, Registered Land Surveyor, or other duly authorized official)

Office of Registrar of Deeds, County of Oneida. I hereby certify that the within instrument was filed in this office for record on the 6th day of November, 1978 at 10:00 o'clock A. M.

Signature Doris Verage Fuchs  
(Registrar of Deeds)

By: \_\_\_\_\_ Deputy

35 10 10 30 10