

CERTIFIED LAND CORNER RESTORATION

Index No. H-20

State of Wisconsin

County of Oneida } ss.

I, Philip T. Hansen, do hereby certify that on the 29th day of December, 1978, I found evidence of the SE 1/16 corner of Section 11 Township 35, North, Range 10 East, Fourth Principal Meridian, as described hereon; and that from this evidence I established a new monument and accessories as described hereon to perpetuate the original location of this corner.

Resident witnesses:

Jim Clafflin

John Masbaum

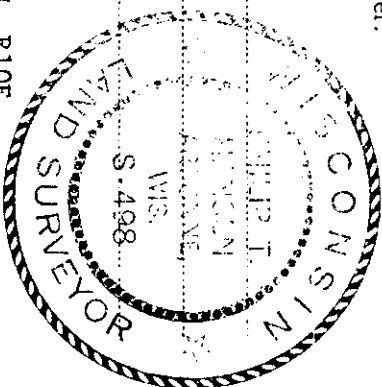

T35N R10E

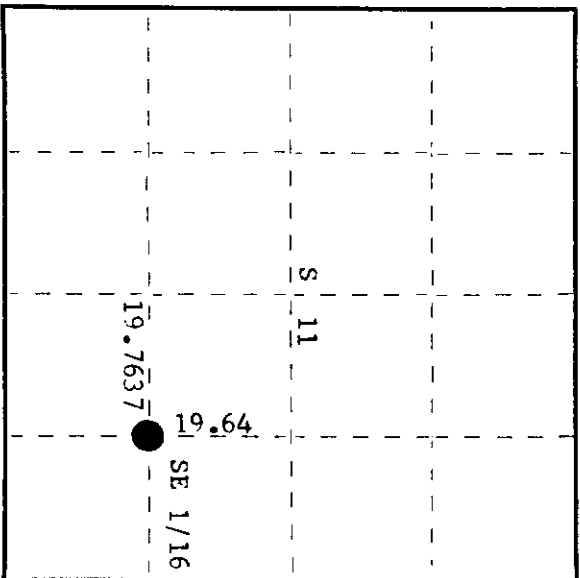

○ = Corner monument restored.

History of original corner establishment:

Corner established by N. Loftus, Ripco surveyor, in 1961.
Ran random line east, bearing 87° 55' magnetic from SC 1/16, previously established 39.5275 chains to close out on S 1/16, departure 25.7 links south. Set SE 1/16 at 19.7637 chains and 12.85 links north.
Marked NBT's -
Oak 5" N9°W 48 links
Spruce 4" N83°W 34.8 links

Description of corner evidence found:

Recovered Ripco's 3/4" iron pipe with 2" diameter alloy cap in good condition but projecting too high. H.C. Lawrence's 5" squared cedar post bears N72°W 10.7 links. H.C. Lawrence has no notes as to the basis for his location.
Recovered OBT's -
Oak 5" (7") N9°W 48.0 links, scribing grown over.
Spruce 4" (6") S83°W 34.8 links, scribing partially legible. Cap stamped: S11 SE 1/16 RIPCO

Description of monument and accessories I established to perpetuate the original location of this corner.

Reset iron pipe in same hole, now projects 1 1/2' above ground.
No additional accessories established.

Dated at Rhineland, Wis. this 4th day of January, 1979.

Signature Philip T. Hansen Title Registered Land Surveyor Registration No. S-498
(County Surveyor, Registered Land Surveyor, or other duly authorized official)

Office of Register of Deeds, County of Oneida
Instrument was filed in this office for record on the 25th day of January, 1979
at 11:50 o'clock P. M. I hereby certify that the within

Doris Hennage Truehr
(Register of Deeds)

By _____ Deputy

35101180