

CERTIFIED LAND CORNER RESTORATION

Index No. **J-25**

State of Wisconsin

County of Oneida } ss.

I Phillip T. Hansen, do hereby

certify that on the 13th day of August, 1975, I found

evidence of the Section 12-7, 18-13

corner of Sections 12-7, 18-13 Township 35, North, Range 10 and 11 East, Fourth Principal Meridian,

as described hereon; and that from this evidence I established a new monument and accessories as described hereon to perpetuate the original location of this corner.

Resident witnesses:

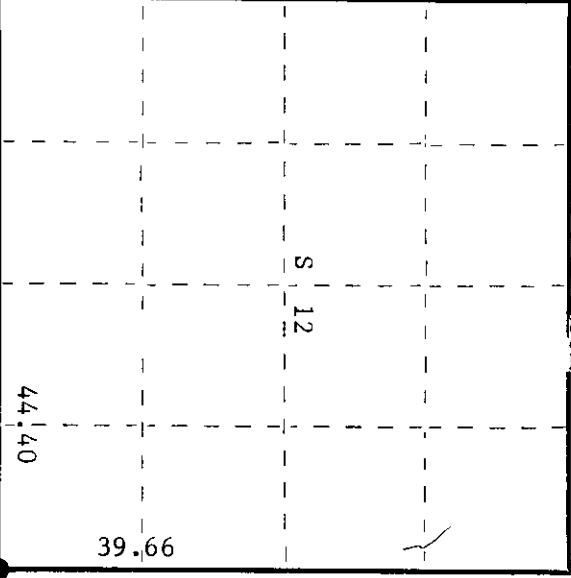
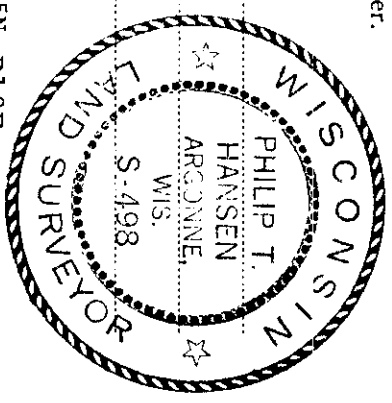

○ = Corner monument restored.

0000000000

History of original corner establishment: Corner established by Alfred Millard, Government Deputy Surveyor, in 1958, from which spruce 12" bears N60°W 35 links, cherry 14" bears N71°E 35 links, cherry 10" bears S57°E 48 links, and yellow birch 14" bears S59°W 61 links.

Corner restored by D.H. Vaughan, County Surveyor, established NBT - spruce 12" N53°E 61 links. Cedar S53°W 89 links. H.C. Hall restored corner, established spruce 8" N54°E 100 links and cedar 9" S65°W 109 links.

Corner recovered and restored by H.C. Lawrence, Reg. Land Surveyor, in 1949. Recovered Vaughan's and Hall's BT's. Set new post and marked NBT - tamarack 8" N37°E 47 links.

Description of corner evidence found:

Recovered Lawrence's 4" cedar post, squared and scribed S7, T35N, S12, S13 R10E, S18 R11E in fair condition; also a 3" cedar post, squared and scribed S13, S18 in poor condition. Also recovered two old points and a 1-1/2" x 12" iron pipe buried in muck beside it.

Recovered OBT - Tamarack 9" N37°E 47 links.

Description of monument and accessories I established to perpetuate the original location of this corner.

Replaced 4" cedar post with 2-1/2" iron pipe with brass cap stamped -

NBT - Red maple 11" S60°W 123.2 links scribed SC BT.

S498  
T35N

R	S12	S7	R
10	S13	S18	11
E			E

CPI-1975

Dated at Rhineland, Wis., this 8th day of September, 1975.

Signature Phillip T. Hansen Title Registered Land Surveyor Registration No. S-498  
(County Surveyor, Registered Land Surveyor, or other duly authorized official)

Office of Register of Deeds, County of Oneida I hereby certify that the within instrument was filed in this office for record on the 14th day of October, 1975 at 2:00 o'clock P. M.

Dona George Kuehn  
(Register of Deeds)

By \_\_\_\_\_ Deputy