

CERTIFIED LAND CORNER RESTORATION

Index No. J-24

State of Wisconsin

County of Oneida

ss.

I Phillip T. Hansen, do hereby certify that on the 15th day of March, 19 78, I found evidence of the E 1/16 corner of Sections 12 and 13 Township 35 North, Range 10 East, Fourth Principal Meridian,

as described hereon; and that from this evidence I established a new monument and accessories as described hereon to perpetuate the original location of this corner.

Resident witnesses:

Glen Barker

Jim Clafflin

Herb Wagoner

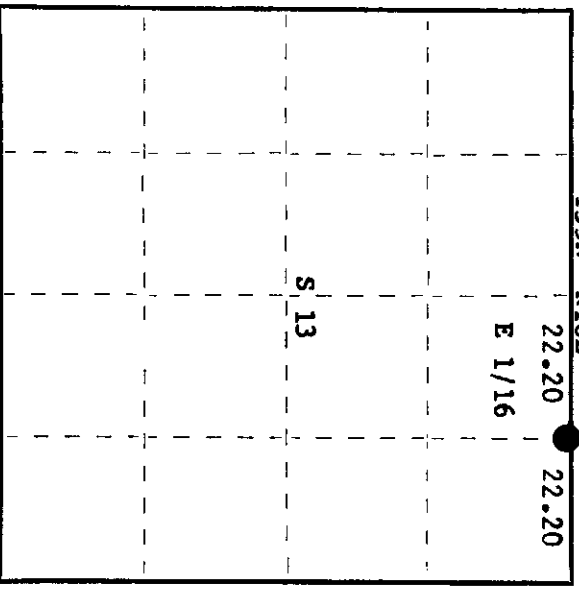
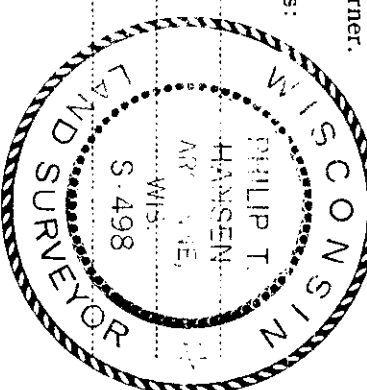

○ = Corner monument restored.

History of original corner establishment:

Corner established by H.C. Lawrence in 1949. Ran 888°E on random from 1/4 corner between 12 and 13, 44.40 chains; closed out 100 links south of section corner 12-13 - 35-10 and 7-8 - 35-11 true line 889° 17' E. Set E 1/16 50 links north of 22.20 chains.

Set 5" cedar post and 1 1/2" iron pipe for E 1/16.

BT's - White Birch 5" S 50° W, 17 links

White Birch 6" S 75° E, 27 links

Basswood 12" N25°W, 97 links

Description of corner evidence found:

Recovered H.C. Lawrence's 5" cedar post squared and scribed E 1/16 - S12 - E 1/16 - S13 standing in fair condition, also his 1 1/2" iron pipe beside post. Recovered OBT's - White Birch 5" (10") S50°W (S58°W) 17 links (16 links), scribing grown over. White Birch 6" (10") S75°E, 27 links (28 links), scribing partly visible Basswood 12" (16") N25°W (N20°W) 97 links, scribed BT

Description of monument and accessories I established to perpetuate the original location of this corner.

Replaced post with a 1 1/2" iron pipe with brass cap, stamped: Projects 18" above ground.

NBT's - Maple 6" S70°W, 26.7 links

Sugar 8" N60°E, 25.9 links

scribed 1/16 BT

5498

T35N R10E

E 1/16 S 12

S 13

CPI-1978

Dated at Rhinelander, Wis., this 31st day of March, 19 78

Signature Phillip T. Hansen Title Registered Land Surveyor Registration No. S-498
(County Surveyor, Registered Land Surveyor, or other duly authorized official)

Office of Register of Deeds, County of Oneida
Instrument was filed in this office for record on the 10th day of April, 19 78
at 10:30 o'clock A. M.

Doris Terage Kuehn
(Register of Deeds)

By _____ Deputy

3510120010