

CERTIFIED LAND CORNER RESTORATION

Index No. **H-25**

State of Wisconsin } ss.  
 County of Oneida

I Philip T. Hansen, do hereby certify that on the 13th day of August, 1975, I found evidence of the S-1/16 corner of Sections 12 and 7 Township 35 North, Range 10 and 11 East, Fourth Principal Meridian, as described hereon; and that from this evidence I established a new monument and accessories as described hereon to perpetuate the original location of this corner.

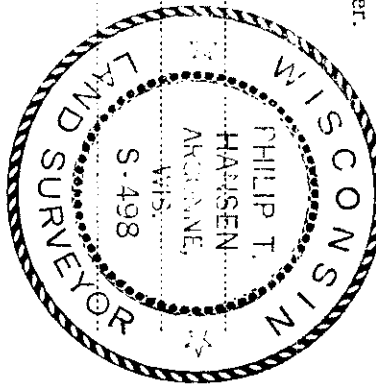

Resident witnesses:

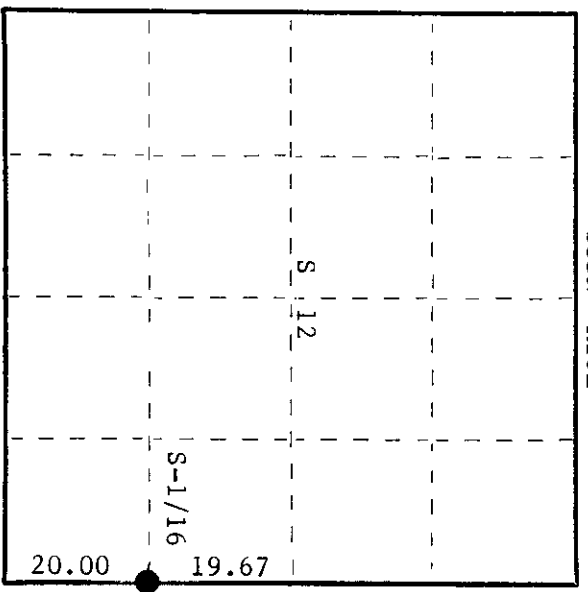

○ = Corner monument restored.

CERTIFIED LAND CORNER RESTORATION

History of original corner establishment: Corner restored by H.C. Lawrence, Registered Land Surveyor, in 1949, during his retracement survey. He ran south from NE Corner, Section 12, and at 59.00 chains. Recovered a 3/4" bolt with 2-1/2" x 2-1/2" not driven in ground. This was 92 links east of the center line of the road. Set new cedar post and marked NBT's - elm 14" N52°E 16 links, elm 9" S37°W 34-1/2 links. Highline pole 1394 bears N88°W.

Description of corner evidence found:

- Recovered 4" cedar post, squared and scribed S-1/16 S7, S-1/16 S12 in fair condition with a rock carron around it; also a 3/4" x 4' iron bolt, driven in ground beside it.
- Recovered OBT's - Elm 14" (16") N52°E (N56°E) 16 links scribing grown over.
- Elm 9" S37°W (S39°W) 34.5 links scribing grown over.

Description of monument and accessories I established to perpetuate the original location of this corner.  
 Replaced wooden stake with 1-1/2" O.D. iron pipe with 2" brass cap stamped -

No additional accessories established.

R	10	S-1/16	S12	S7	R
E			CPI-1975		E

S498  
T35N

Dated at Rhineland, Wis., this 8th day of September, 1975.

Signature *Philip T. Hansen* Title Registered Land Surveyor Registration No. S-498  
 (County Surveyor, Registered Land Surveyor, or other duly authorized official)

Office of Register of Deeds, County of Oneida  
 Instrument was filed in his office for record on the 14th day of October, 1975  
 at 2:00 o'clock P.M.

*Donis George Kuehn*  
 (Register of Deeds)

By Deputy

3510121000