

This form is intended to fulfill the requirements of Chapter A-E 7.08 (3)(a) thru (i) U.S. Public Land Survey Monument Location Record, Wisconsin Administrative Code. Use the reverse side of form for continuation.

U.S. PUBLIC LAND SURVEY MONUMENT LOCATION RECORD

Recorders Data

USPLS CORNER: NORTH WITNESS MC SECTION: 13 TOWNSHIP: 35 NORTH RANGE: 10 EAST

NAME OF WATERWAY FOR M.C. CORNER: PELICAN LAKE SECTION LINE: WEST

(CITY)(VILLAGE)(TOWN) OF: SCHOEPEKE COUNTY OF: ONEIDA

Description of monument found or placed and all other evidence used as the basis for monument location; including monuments and related measurements required if the corner location was reestablished by lost corner proportionate methods. Also indicate name of original surveyor, original survey date and the corner monument, bearing trees, witness or other reference monuments established; including measured bearing and distance ties, from available records.

Found an old 2" dia. iron pipe with 3/4" dia. iron pipe in top and old red top yellow painted wood marker stake nearby. I removed the 30" long 2" iron pipe and 36" long 3/4" iron pipe and drove a standard 2" dia. by 30" long aluminum pipe monument with cast aluminum point and stamped Oneida County cap into plumb soil cavity left by old pipes to 12" above grade and piled nearby rocks and pieces of broken concrete found nearby around the monument as a protective cairn. I left old iron pipes flat on grade nearby.

In September 1865, James Nowlin set a wood post as original corner and marked OBTs: a 3" Oak S89°E 20 links and a 12" Bw N40°E 50 links; all now obliterated. In September 1910, D.H. Vaughan commenced a survey at this Witness MC corner per Oneida County survey records. In September 1912, Walter E. Hoffman/GLO indicates the original MC on Plat of Island in Pelican Lake he had surveyed per GLO Special Instructions dated June 28, 1912; post is now obliterated. In 1920, D.H. Vaughan commenced a survey at this Witness MC per Oneida County survey records. In 1941, V.M. Maine notes the "original Govt. MC on Pelican Lake between Secs 13 & 14" and also noted GLO OBTs, but does not indicate if actually found or not. In 1970, William Cameron/RLS 112 notes a 1" iron pipe found as Witness MC and an 18" Bw BT N82°E 17.0', now gone, per Maccabee Plat filed as C-99 in Oneida County records and also notes the same Witness MC iron pipe in 1971 per Plat of Survey C-346 in Oneida County survey records. In July 1976, William F. Kelly/RLS 1098 notes a 2" iron pipe found at this Witness MC per Certified Survey Map No. 297 in Oneida County records.

This recovery completed October 4, 2001 and was directly witnessed by South adjoiner/owner Michael R. Reese at Fire No. 1050 Chicago Point Road.

Plan view map of monument location with bearing and distance ties to a minimum of four(4) described witness or reference monuments of concrete, natural stone, iron, live bearing trees or equivalent material. If applicable, also show a minimum of two(2) bearing and distance ties to any other monument found and not accepted; including the bearing and distance from the accepted monument.

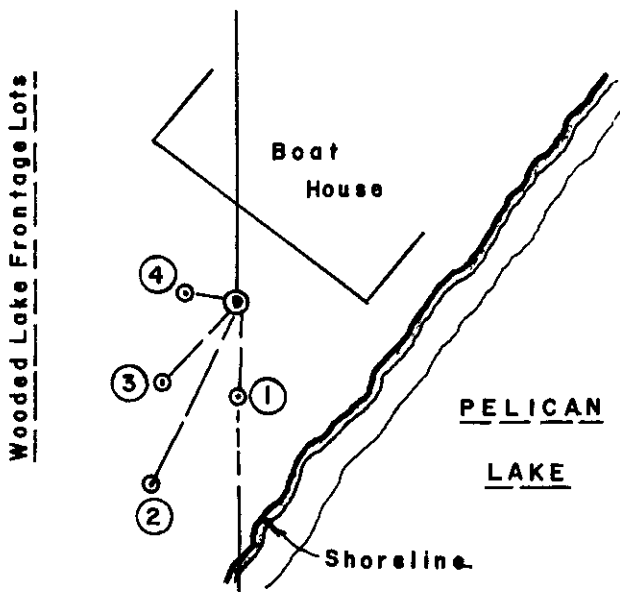

WITNESS MONUMENT TIES:

- ① New BT 13" Oak South 10.08'.
- ② New BT 12" Maple S25°W 21.00'.
- ③ New BT 10" Maple S43°W 11.37'.
- ④ New BT 17" Oak N80°W 5.48'.

SW corner of masonry boat house foundation at grade N28°W 18.8' and SE corner of same at 13.4' East.

Standard white poly 'T' corner marker post set 9" SW of corner monument also located about 14' NW of existing shoreline of Pelican Lake this date.

SCALE: 1" = 20'

Unless otherwise indicated, all bearing tree ties are to a .25" dia. by 2.5" long PK nail with a 1.25" dia. steel washer driven into unblazed right face and a .25" dia. by 2.5" long PK nail with a 2" dia. steel washer stamped BT is also driven into unblazed face of bearing tree at DBH; the basis for measured bearings is by compass to nearest degree and all tie distances are measured horizontal by steel tape corrected to nearest 1/100th feet at standard temperature of 68° F.

RLS SEAL:

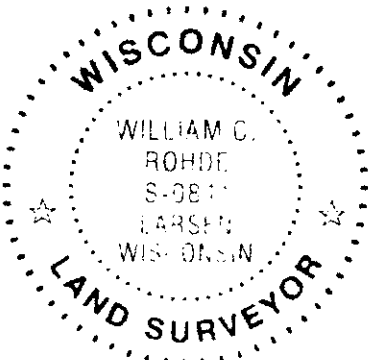

LAND SURVEYOR CERTIFICATE:

I, William C. Rohde, hereby certify that I am duly licensed as a Professional Land Surveyor in the State of Wisconsin; that this USPLS monument location was determined by me and/or under my direct supervision and control; and that this U.S. Public Land Survey Monument Location Record is true and correct to the best of my knowledge and belief.

Signed: *William C. Rohde*
William C. Rohde RLS 841

		T35N	
		13	
		R10E	

SECTION LOCATION MAP
INDEX NO. *M N 25*

3/25/02