

CERTIFIED LAND CORNER RESTORATION

Index No. **0-4**

State of Wisconsin } ss.
County of Oneida

I Phillip T. Hansen, do hereby certify that on the 19th day of October, 1978, I found evidence of the NE 1/16 corner of Section 19 Township 35, North, Range 10 East, Fourth Principal Meridian, as described hereon; and that from this evidence I established a new monument and accessories as described hereon to perpetuate the original location of this corner.

Resident witnesses:
Jim Clafflin
Herb Wagoner

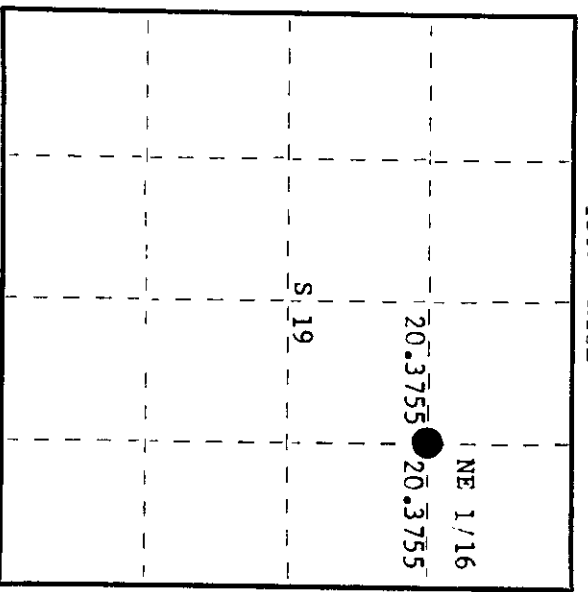
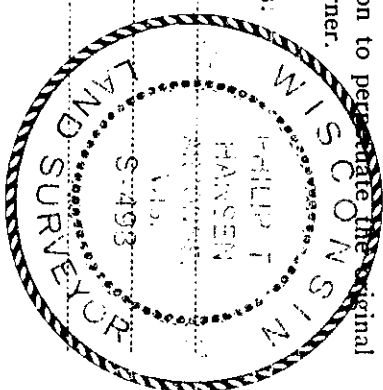

○ = Corner monument restored.

History of original corner establishment:

Corner established by Drivas, Ripco surveyor, in 1961. Ran random line west from previously established N 1/16 east line, 40.751 chains to close out 3 1/2 links north of NC 1/16. Bearing 272° 30' 46" mag.

Set NE 1/16 at 20.3755 chains intermediate.
Marked NBT's - Balsam 7" 884°W 5.7 links
Balsam 6" S10°E 34.3 links
both scribed NE 1/16 S19 BT

Description of corner evidence found:

Recovered 3/4" iron pipe with 2" diameter alloy cap in good condition. There is also a 1/2" iron pipe beside the monument.

Recovered OBT's - Balsam 7" 884°W (N 86° W) 5.7 links, scribed NE 1/16 BT.
Balsam 6" S10°E (S5°E) 34.3 links (now dead).

Monument projects 24" above ground. Cap stamped: NE 1/16
RIPCO

Description of monument and accessories I established to perpetuate the original location of this corner.
Monument left in place as recovered.

Marked NBT's - W. Birch 8" S13°E 38.3 links
W. Birch 6" N12°E 48.1 links
both scribed 1/16 BT

Dated at Rhinelander, Wis., this 13th day of November, 1978.

Signature Phillip T. Hansen Title Registered Land Surveyor Registration No. S-498
(County Surveyor, Registered Land Surveyor, or other duly authorized official)

Office of Register of Deeds, County of Oneida, I hereby certify that the within instrument was filed in this office for record on the 27th day of November, 1978 at 1:00 o'clock P.M.

Dorothy Wagoner Hansen
(Register of Deeds)

By: _____ Deputy

3510193010