

U.S. PUBLIC LAND SURVEY MONUMENT RECORD

Note: This form is intended and designed to fulfill all requirements of Wisconsin Administrative Code, Chapter A-E 5.02, U.S. Public Land Survey Monument Record (3) (a) (b) (c) (d) (e) (f) (g) (h) (i). An additional sheet may be added if necessary to conform with said requirements.

(a) Corner location: Township 35 North
 Range 10 East/West
 Town/~~City/Village~~ ENTERPRISE
 County ONEIDA

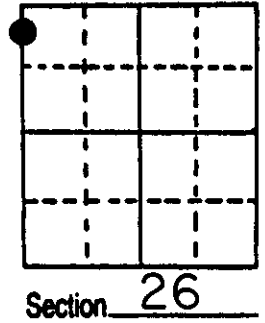

(b) (f) (g) (h) Description of monument found at this corner and if it was accepted, state all evidence (material, testimonial, occupational, plats, records, other monuments) used as a basis for accepting. If not accepted or if nothing was found, state evidence used as basis for establishing location. If reestablished through lost corner proportionate methods, indicate all monuments, distances and directions used to establish.

I found Hall's Y. Pine B.T.s. The recorded distance puts the M.C. over the lakeshore bank. I found an axle shaft at the top of the bank and used same for a witness corner to the M.C.. I made two new B.T.s and recorded new bearings to Hall's B.T.s.

REGISTER OF DEEDS OFFICE
 ONEIDA COUNTY, WIS.

 At 1:39 O'Clock P
 DORIS VERAGE KUEHN
 REGISTER OF DEEDS

(c) (d) (e) Plan view of corner with ties to at least 4 witness monuments. If in disagreement with previously established corner, show the distances between the two corners and also indicate the ties to the disputed corner.

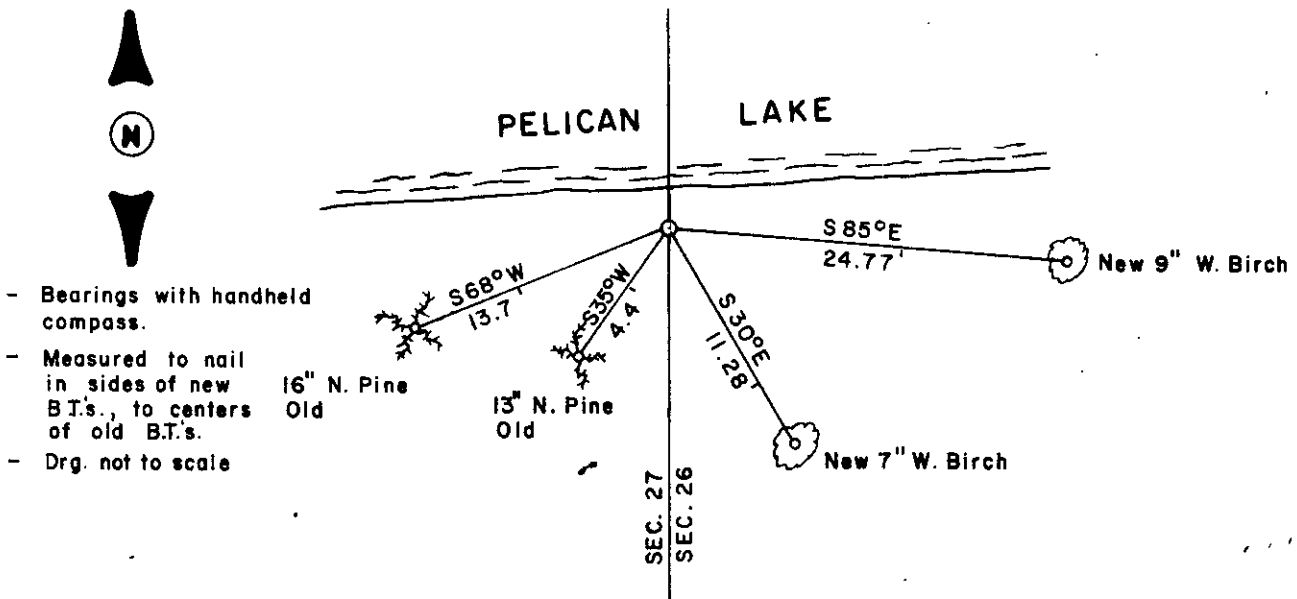

(i) I, WILLIAM E. BANDOW R.L.S. 1182
 (type or print name) certify that the corner location on this record was determined by me or under my direction and control and that this U.S. Public Land Survey Monument Record is correct and complete to the best of my knowledge and belief.

William E. Bandow DEC. 16, 1985
 Signature Date
 GENISOT & ASSOCIATES INC. - 1512 EAGLE ST. - RHINELANDER, WIS.



Index No. P-17
RS-17

3510273400