

CERTIFIED LAND CORNER RESTORATION

Copy from Langlade City

Index No. A-7
35-10

State of Wisconsin

County of LANGLADE } ss.

I WILLIAM F. KELLY, do hereby certify that on the 4th day of DEC., 1981, I found evidence of the N 1/4 corner of SEC. 5 Township 34, North, Range 10 EAST, Fourth Principal Meridian, as described hereon; and that from this evidence I established a new monument and accessories as described hereon to perpetuate the original location of this corner.

Resident witnesses:

History of original corner establishment:

ORIGINAL CORNER ESTABLISHED BY JAMES L. NOWLIN IN JULY, 1865.

RESURVEYED BY TWP. IN 1930'S BY "CCC"

Description of corner evidence found:

4" BRASS CAP MONUMENT,
FOUND IN PLACE.
MARKED 3 NEW B.T.S.



Description of monument and accessories I established to perpetuate the original location of this corner.

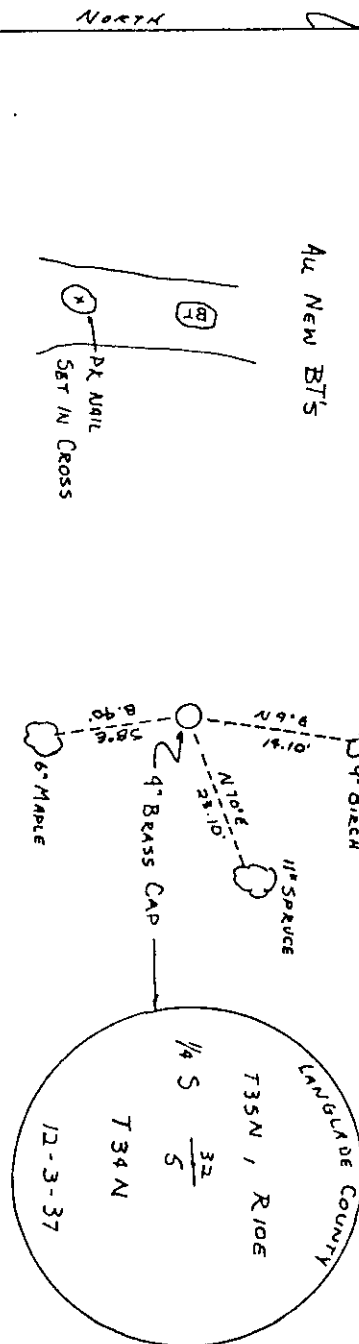

Dated at ELCHO, Wis., this 4th day of DECEMBER, 1981.

Signature William F. Kelly Title COUNTY SURVEYOR Registration No. 1098
(County Surveyor, Registered Land Surveyor, or other duly authorized official)

Office of Register of Deeds, County of LANGLADE. I hereby certify that the within instrument was filed in this office for record on the 19 day of DECEMBER, 1981 at 10 o'clock M.

(Register of Deeds)

By William F. Kelly Deputy

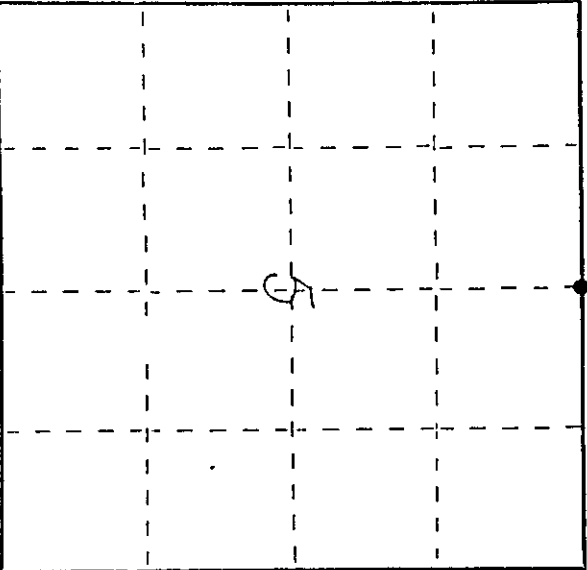

○ = Corner monument restored.