

CERTIFIED LAND CORNER RESTORATION

History of original corner establishment:

State of Wisconsin }
 County of LAWRENCE } ss.

I, WILLIAM F. KELLY, do hereby certify that on the 24TH day of NOVEMBER, 1975, I found evidence of the SECTION corner of SECTIONS 35, 36, & 37 Township 34 North, Range 10E, Fourth Principal Meridian, as described hereon; and that from this evidence I established a new monument and accessories as described hereon to perpetuate the original location of this corner.

Resident witnesses:

Index No. 35-10

2-21

35-10
 COPY FROM
 LAWRENCE CO.

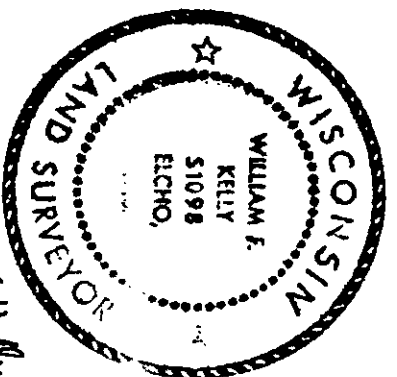

William F. Kelly

Description of corner evidence found:

FOUND WITNESS CORNER MARKED:
 LOCATED OLD B.T. WITH BLAZE AT BASE.

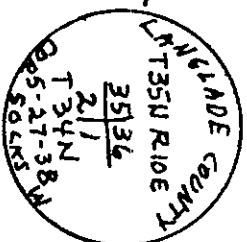

Description of monument and accessories I established to perpetuate the original location of this corner.

QRT 20" HEMLOCK (B.T.)

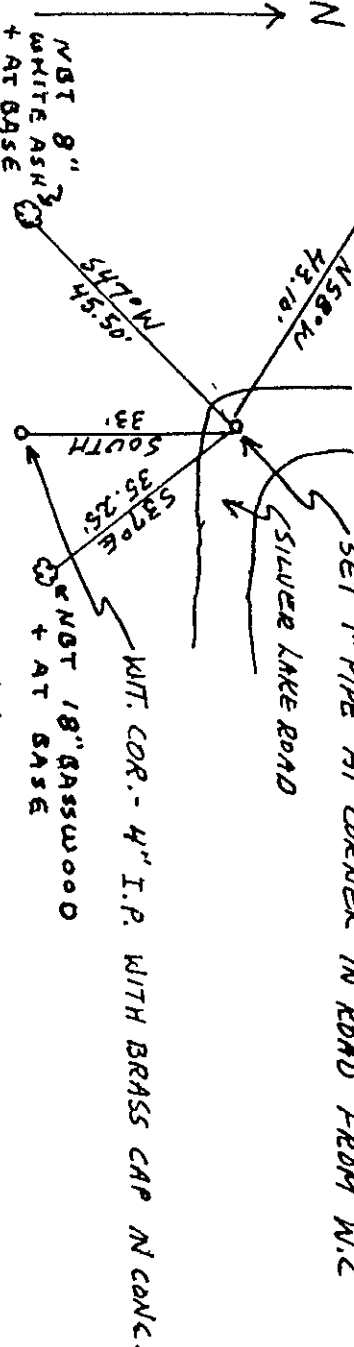

Dated at ELCHO, Wis., this 24TH day of NOVEMBER, 1975.

Signature William F. Kelly Title REGISTERED LAND SURVEYOR Registration No. 51098
 (County Surveyor, Registered Land Surveyor, or other duly authorized official)

Office of Register of Deeds, County of LAWRENCE, I hereby certify that the within instrument was filed in this office for record on the 24TH day of NOVEMBER, 1975 at 10 o'clock A. M.

(Register of Deeds)

By: _____ Deputy

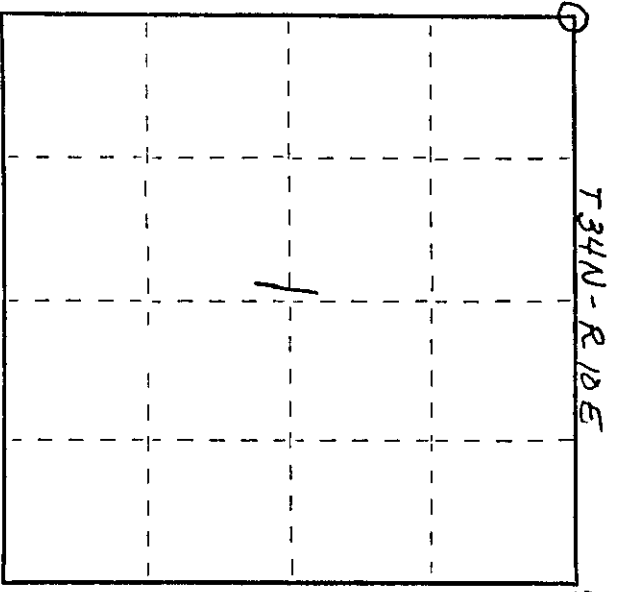

○ = Corner monument restored.