

State of Wisconsin
 County of LANGLADE } ss.

I WILLIAM F. KELLY, do hereby
 certify that on the 21ST day
 of NOVEMBER, 1975, I found
 evidence of the SECTION
 corner of SECTION 36, 31, 1 & 6
 Township 34 North, Range
10E & 11E, Fourth Principal Meridian,
 as described hereon; and that from this evidence
 I established a new monument and accessories
 as described hereon to perpetuate the original
 location of this corner.

Resident witnesses:

CERTIFIED LAND CORNER RESTORATION

History of original corner establishment:

Description of corner evidence found:
 LOCATED SECTION COR. 36 | 31 T. 35. N. R. 10E - R. 11E.
1 | 6 T. 34 N. R. 10E. - R. 11E.

EXISTING 4" PIPE WITH CONC. BENT OVER WITH 1/2 OF BRASS CAP MISSING.

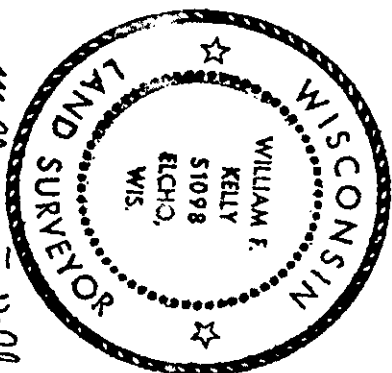

William F. Kelly

Index No. 4-25

2-25
35-10

*Copy from
 Langlade City*

351036000

Description of monument and accessories I established to perpetuate the original location of this corner.

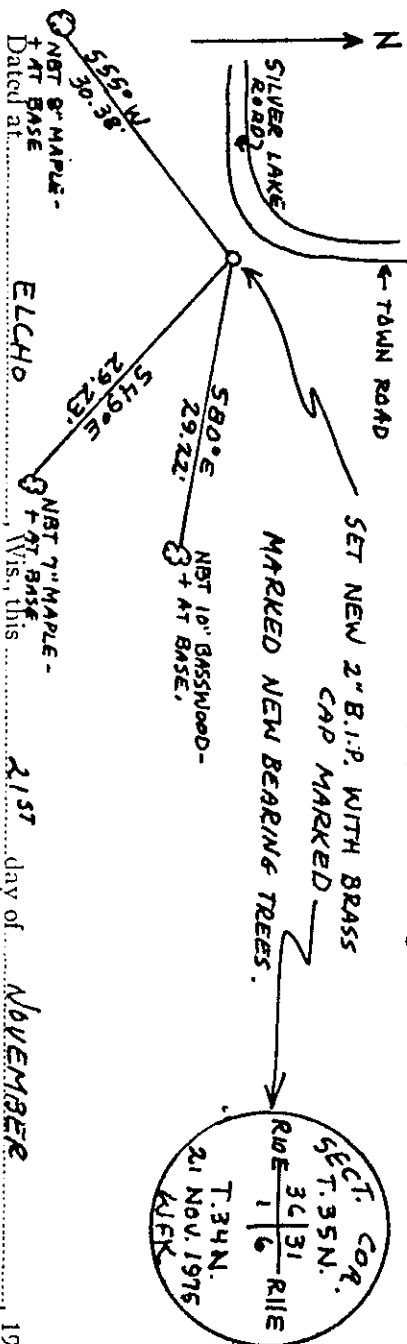

Signature: William F. Kelly Title: REGISTERED LAND SURVEYOR Registration No. 51098
 (County Surveyor, Registered Land Surveyor, or other duly authorized official)

Office of Register of Deeds, County of _____, I hereby certify that the within
 instrument was filed in this office for record on the _____ day of _____, 19____
 at _____ o'clock _____ M.

(Register of Deeds)

By: _____ Deputy

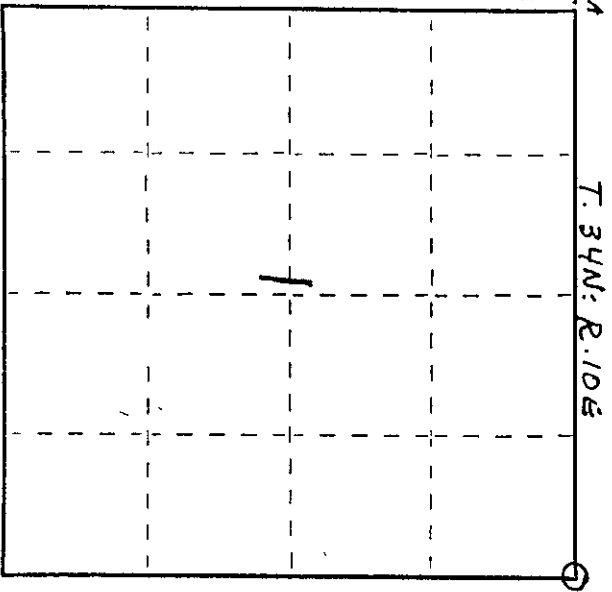

○ = Corner monument restored.

CERTIFIED LAND CORNER RESTORATION

Z - 25
Index No. ~~9~~ 1

34-10

State of Wisconsin

County of LANSKRAE } ss.

I, WILLIAM F. KELLY, do hereby certify that on the 18th day of Dec., 1981, I found evidence of the NE corner of SEC. 1 Township 34, North, Range 9 EAST, Fourth Principal Meridian, as described hereon; and that from this evidence I established a new monument and accessories as described hereon to perpetuate the original location of this corner.

Resident witnesses:

.....
.....

History of original corner establishment:

ORIGINAL CORNER ESTABLISHED BY JAMES L NOWLIN IN SEPT. OCT, 1864.

MONUMENT SET ON SURVEY FOR RHINSLANDER PAPER COMPANY IN 1957

Description of corner evidence found:
2" BRASS CAP MONUMENT,
FOUND IN PLACE.

LOCATION TAG ON 18" OAK SIGNED: SE BANISH 10/21/57
J R SPOERKE

FERRY KAYKA 9/11/69
MARKED 3 BT'S.

Description of monument and accessories I established to perpetuate the original location of this corner.

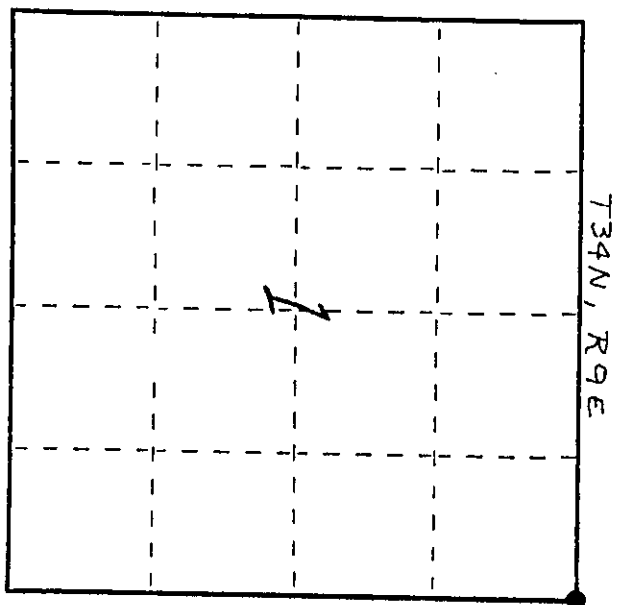
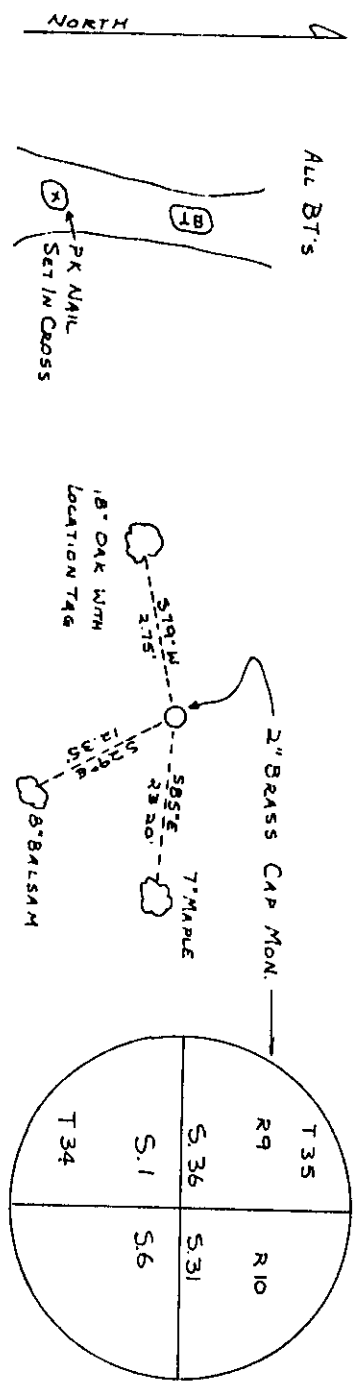

O = Corner monument restored.

Dated at ELCHO, Wis., this 18th day of DEC., 1981

Signature William F. Kelly Title COUNTY SURVEYOR Registration No. 1098
(County Surveyor, Registered Land Surveyor, or other duly authorized official)

Office of Register of Deeds, County of LANSCRAE, I hereby certify that the within instrument was filed in this office for record on the 18th day of DEC., 1981 at 10 o'clock M.

By (Register of Deeds)

By Deputy

COPY FROM LANGLADE CTY