

CERTIFIED LAND CORNER RESTORATION

Index No. **Y-24**

State of Wisconsin } ss.
 County of Oneida

History of original corner establishment: Corner established by H.C. Lawrence, registered Land Surveyor, in 1957. From established JO 1/16 corner he ran south 0° 30' E 110.6 highway 45. Set JO 1/16 19.74 chains south of JO 1/16 and 20.69 chains east of the JO 1/16 corner. Set 4" cedar post, squared and scribed.

I Phillip T. Hansen do hereby certify that on the 8th day of April, 1976, I found evidence of the SE 1/16 corner of Section 36 Township 35, North, Range 10 East, Fourth Principal Meridian, as described hereon; and that from this evidence I established a new monument and accessories as described hereon to perpetuate the original location of this corner.

Description of corner evidence found: recovered 4" cedar post, squared and scribed SE 1/16 JO, JO 1/16 JO JO in poor condition. Found a rock cairn around base. Corner sets in road bed of old highway 45. No MBTs were visible and none on record.

Resident witnesses:

Glen Barker
Jim Claflin
Herb Wagoner

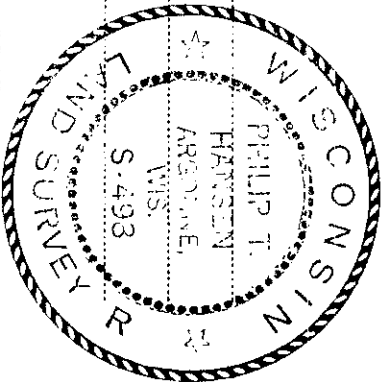

Description of monument and accessories I established to perpetuate the original location of this corner.
 Replaced 4" cedar post with 1 1/2" iron pipe with 2" brass cap stumped.
 Pipe projects 2 ft. above ground.
 MBTs - Sugar 10" S 71° E 81 lks, scribed 1/16 BT.
 Sugar 12" W 54° E 110.1 lks, scribed 1/16 BT.
 Monument and BTs painted blue.

S498
 T35N R10E
 SE 1/16 S 36
 CPT-1976

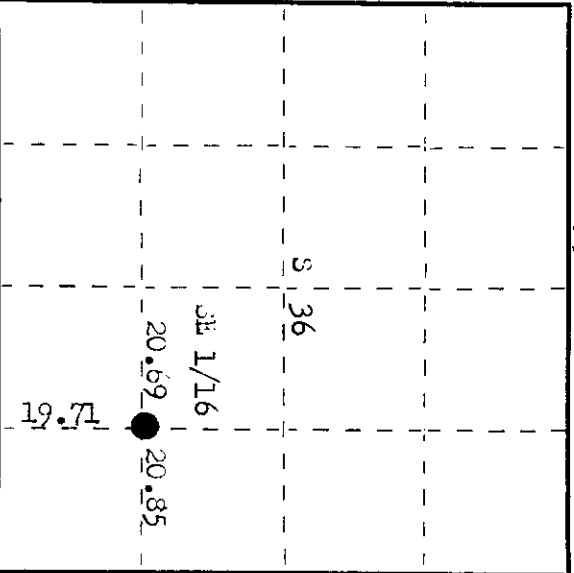

○ = Corner monument restored.

Dated at Oneida, Wis., this 12th day of July, 1976

Signature Phillip T. Hansen Title Registered Land Surveyor Registration No. S-498
 County Surveyor, Registered Land Surveyor, or other duly authorized official

Office of Register of Deeds, County of Oneida I hereby certify that the within instrument was filed in this office for record on the 23rd day of July, 1976 at 1:30 o'clock P.M.

Doris Verage Fieckel
 (Register of Deeds)

By: _____ Deputy

3510361010