

CERTIFIED LAND CORNER RESTORATION

Index No. B-21

State of Wisconsin }
County of Oneida } ss.

I Phillip T. Hansen, do hereby
certify that on the 21st day
of December, 1976, I found

evidence of the N 1/16
corner of Section 1 & 2

Township 35, North, Range
11 East, Fourth Principal Meridian,

as described hereon; and that from this evidence
I established a new monument and accessories
as described hereon to perpetuate the original
location of this corner.

Resident witnesses:

Jim Clarlin

Herb Wagoner

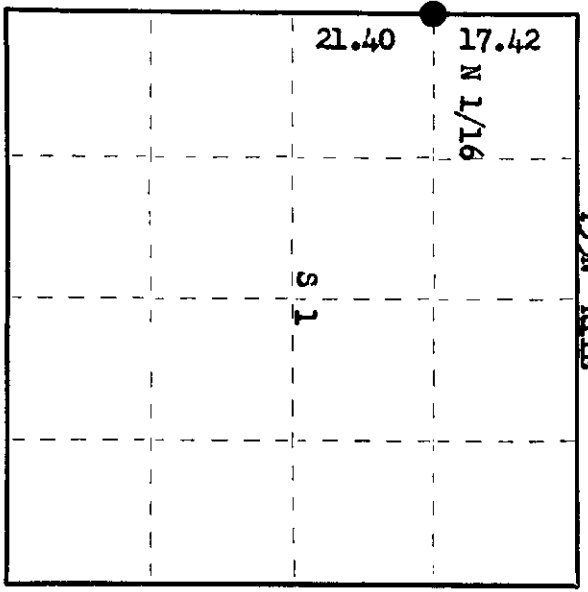
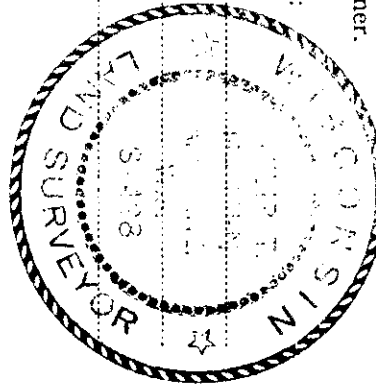

○ = Corner monument restored.

History of original corner establishment:

Corner established by H.C. Lawrence, Registered Land Surveyor, in 1957.
From Section Corner Sec. 1, 2, 11 & 12, he ran a random line N 15° 00' W a distance of
81.62 chains to close out 3.45 chains west of Sec. Corner 35, 36, 1 & 2.
Corrected bearing N 12° 36' W. Established the N 1/16 corner at 64.20 chains and
270 links east.
Set 5" cedar post. Nothing available for BT. All alder and brush.

Description of corner evidence found:

Recovered 5" squared and scribed cedar post in fair condition, scribed SL N 1/16 S2 N 1/16.
No BTs recovered.

Description of monument and accessories I established to perpetuate the original location of this corner.

Replaced cedar post with 1 1/2" iron pipe with 2" brass cap stamped:
Monument projects 20" above ground.
NBT - Tamarrack 3" S 68° W 96.8 links, scribed BT.

S498
T35N R11E
N 1/16 2 1/2
CPI-1976

Dated at Rhineland, Wis., this 22nd day of December, 1976.

Signature Phillip T. Hansen Title Registered Land Surveyor Registration No. S-498
(County Surveyor, Registered Land Surveyor, or other duly authorized official)

Office of Register of Deeds, County of Oneida
Instrument was filed in this office for record on the 24th day of February, 1977
at 102 o'clock P. M.

Doree Terage Kuehn
(Register of Deeds)

By _____ Deputy

351102200