

CERTIFIED LAND CORNER RESTORATION

Index No. **B-13**

State of Wisconsin }
 County of Oneida } ss.

I Phillip T. Hansen, do hereby certify that on the 8th day of July, 1975, I found evidence of the N-1/16 corner of Sections 3 and 4 Township 35 North, Range 11 East, Fourth Principal Meridian, as described hereon; and that from this evidence I established a new monument and accessories as described hereon to perpetuate the original location of this corner.

Resident witnesses:

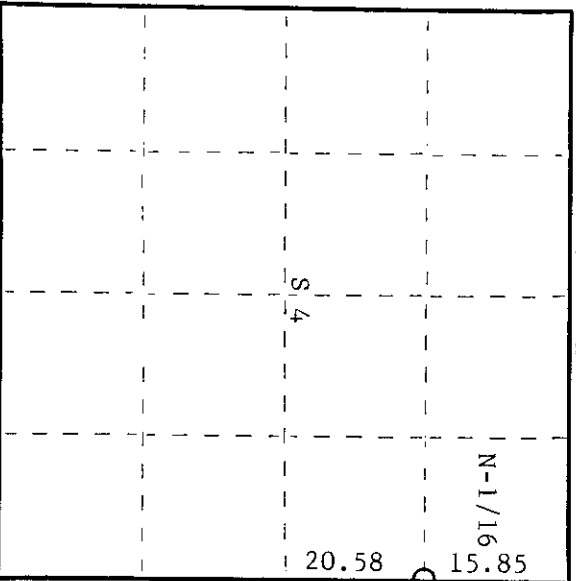
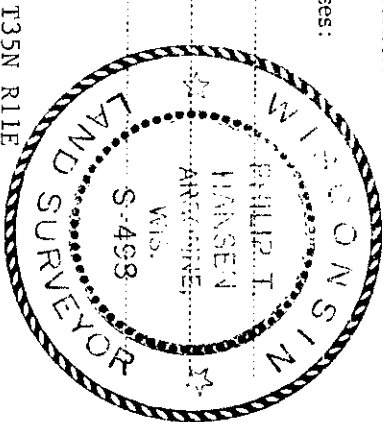

○ = Corner monument restored.

History of original corner establishment:

Corner established by D.H. Vaughan, County Surveyor, in 1906. From NE corner Section 4, perpetuated by B.F. Dorr, and restored by Vaughan, he ran 49° east and at 86.43 chains he fell 5.55 chains west of E 1/2 post. Found original tree and stump of another one. Had an overrun of 1.03 chains. Proportioned overrun and set N-1/8 on east line 15.85 chains south of northeast corner. Corrected line 120/40 var. Made Br's - maple 10" N769E 23-3/4 links, and birch 24" S310W 23 1/2 links. Corner recovered by H.C. Lawrence, Registered Land Surveyor, in 1953. Recovered Vaughan's birch BT S310W, now a stump. Set new post. Made NBr's - sugar 14" S3°00'W 62 links, and sugar 18" N50°E 80 1/2 links.

Recovered 5" cedar post, squared and scribed S3 N-1/16 S4, in poor condition.

Recovered OBr's - sugar 18" N50°E 80.5 links - now a cut-off stump.

Sugar 14" (16") S3°W 62 links - scribing grown over.

Description of monument and accessories I established to perpetuate the original location of this corner. Replaced 5" cedar post with 1 1/2" O.D. iron pipe with brass cap stamped -

NBT - white birch 7" S54°E 26.1 links - scribed 1/16 BT.

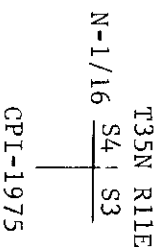

Dated at Rhinelander, Wis. this 24th day of July, 1975.

Signature *Phillip T. Hansen* Title Registered Land Surveyor Registration No. S-498
 (County Surveyor, Registered Land Surveyor, or other duly authorized official)

Office of Register of Deeds, County of Oneida
 Instrument was filed in this office for record on the 1st day of October, 1975 at 3:00 o'clock P.M.
 I hereby certify that the within

Dora Savage Kiehn
 (Register of Deeds)

By Deputy

3511043000