

CERTIFIED LAND CORNER RESTORATION

Index No. D-5

State of Wisconsin }
County of Oneida } ss.

I Phillip T. Hansen, do hereby certify that on the 11th day of September, 1976, I found evidence of the S. 1/16 corner of Sections 5 and 6 Township 35, North, Range 11 East, Fourth Principal Meridian, as described hereon; and that from this evidence I established a new monument and accessories as described hereon to perpetuate the original location of this corner.

Resident witnesses:
Glen Barker
Jim Claflin
Herb Wagoner

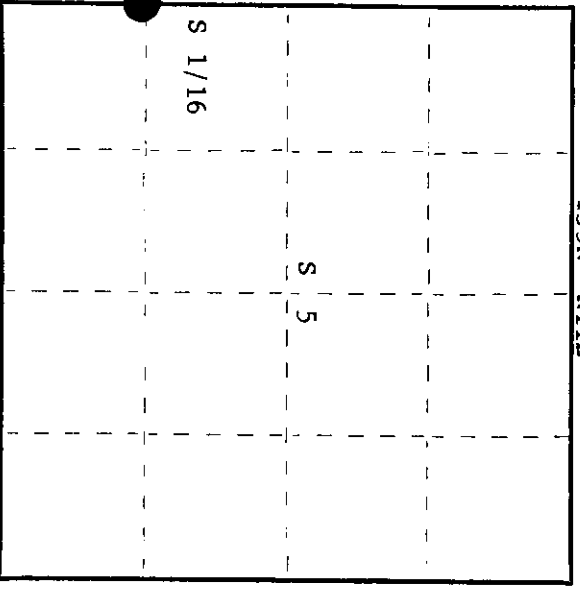
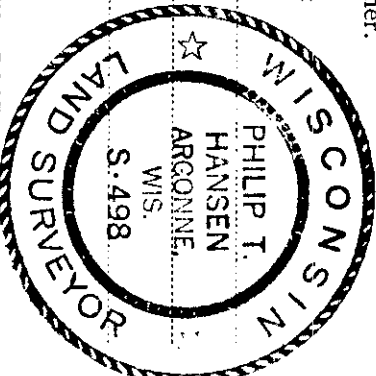

○ = Corner monument restored.

History of original corner establishment:

Corner established by V.M. Maine, county surveyor. H.C. Lawrence, Registered Land Surveyor, recovered his corner in 1954. Ran random line north from section corners 5, 6, 7 and 8. No evidence of any BT's recovered.

Description of corner evidence found:

Recovered Maine's 6" cedar post, scribed 1/8 S 1/8 S in poor condition.

No records or evidence of any BT's recovered.

Description of monument and accessories I established to perpetuate the original location of this corner.

Replaced wood post with 1-1/2" iron pipe with 2" brass cap, stamped: Monument projects 18".
Marked NBT's - Sugar 6" S48°W 5.5 links, scribed 1/16 BT. S498 T35N R11E
Sugar 6" N36°W 61.6 links, scribed 1/16 BT. S 1/16 6+5
CPI-1976

Dated at Rhineland, Wis. this 2nd day of January, 1980

Signature: Phillip T. Hansen Title: Registered Land Surveyor Registration No. S-498
(County Surveyor, Registered Land Surveyor, or other duly authorized official)

Office of Register of Deeds, County of Oneida, I hereby certify that the within instrument was filed in this office for record on the 14th day of January, 1980 at 1:30 o'clock P. M.

Toni Savage Tucker
(Register of Deeds)

By: _____ Deputy

3511061000