

CERTIFIED LAND CORNER RESTORATION

Index No. **B-5**

State of Wisconsin }  
 County of Oneida } ss.

History of original corner establishment:

M.C. Lawrence, registered land surveyor, recovered V.M. Maine's 1/16 in 1954, a wood post 3" diameter, was set from Maine's two spruce trees.

I, Phillip P. Hansen, do hereby certify that on the 9th day of November, 1976, I found evidence of the N 1/16 corner of Section 5 & 6 Township 35, North, Range 11 East, Fourth Principal Meridian, as described hereon; and that from this evidence I established a new monument and accessories as described hereon to perpetuate the original location of this corner.

Resident witnesses:

Glen Barker

Jim Clafflin

Herb Larson

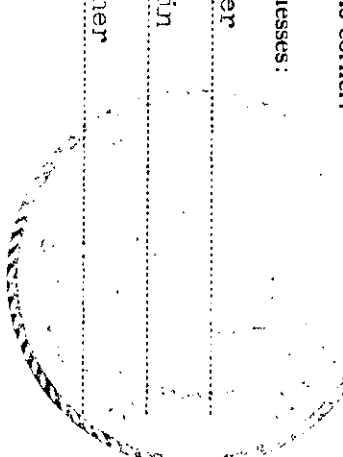

Description of corner evidence found:

Recovered Lawrence's 3" diameter post, squared and scribed 1/16 on, a 1/16 on in good condition, recovered Maine's black spruce stump 7" x 11 links, scribed 1/8 on.

Description of monument and accessories I established to perpetuate the original location of this corner.

Replaced tamarack post with 1 1/2" OD iron pipe with 2" brass cap, stamped: Monument projects 18" above ground.  
 RT - Black spruce 6" x 35" x 45.3 links, scribed 1/16 RT.  
 Tamarack 5" x 28" x 37.6 links, scribed 1/16 RT.

3498  
 N 1/16 6 1/2  
 T35N R11E  
 0-1-1976

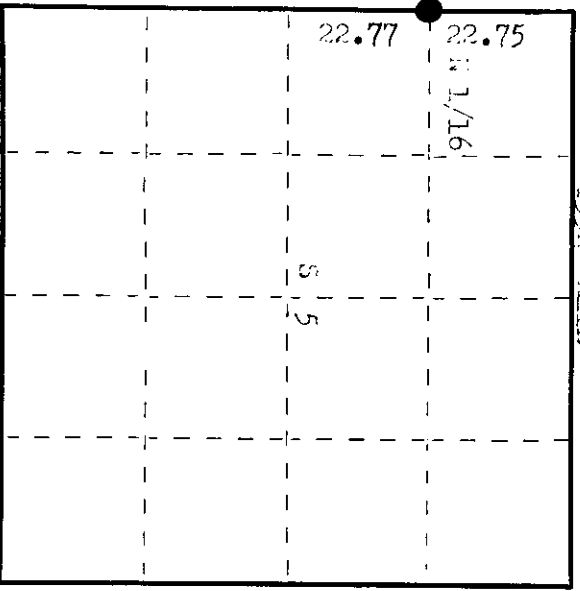

○ = Corner monument restored.

Dated at Oneida, Wis., this 1st day of December, 1976.

Signature Phillip P. Hansen Title Registered Land Surveyor Registration No. 3498  
 (County Surveyor, Registered Land Surveyor, or other duly authorized official)

Office of Register of Deeds, County of Oneida. I hereby certify that the within instrument was filed in this office for record on the 9th day of December, 1976 at 2:05 o'clock P. M.

Terrie Debra Kuehn  
 (Register of Deeds)

By Joseph M. Borman Deputy

3511063000