

CERTIFIED LAND CORNER RESTORATION

Index No. 5-21

State of Wisconsin }
 County of Oneida } ss.

I, Phillip T. Hansen, do hereby certify that on the 29th day of May, 1975, I found evidence of the Section Corner corner of S11, 12, 13, 14 Township 11 East, Range 11 East, Fourth Principal Meridian, as described hereon; and that from this evidence I established a new monument and accessories as described hereon to perpetuate the original location of this corner.

Resident witnesses:

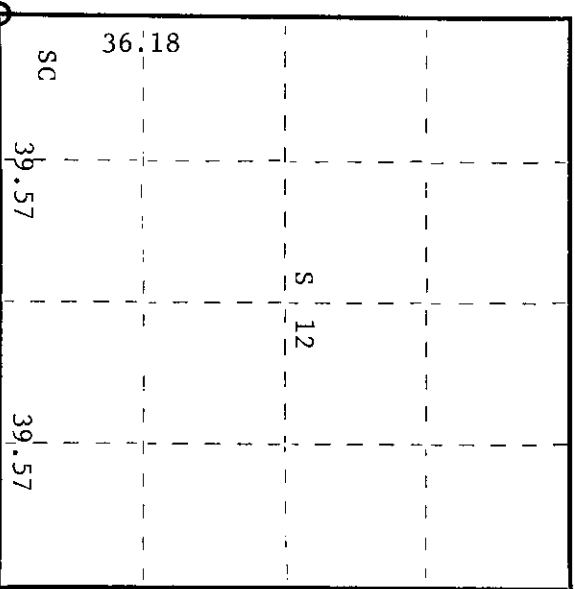
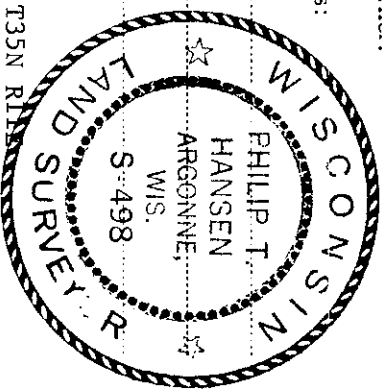

○ = Corner monument restored.

History of original corner establishment:

Original corner established by Wm. E. Dougherty, Gov. Deputy Surveyor, in 1859, from which white birch 7" bears S33°E 24 links and aspen 12" bears N89°W 19 links. Corner recovered by D.H. Vaughan, County Surveyor, in 1914. He states that he ran west from the SE corner Sec. 12, Var. 1-1/2°E a distance of 79.14 chains. Fell 4.19 chains south of SW corner. Found original trees.

Corner re-established by H.C. Lawrence, Registered Land Surveyor, from corner of section 7-12-13-18, centerline of N-S county line road, he ran west 79.14 chains, Vaughan's record distance. Set 4" cedar post 38.16 chains south of W-1/4 corner. Scribbled an elm 16" 22 links west of corner.

Description of corner evidence found:
 Recovered 4" cedar post, squared and scribed S11, S12, S13, S14, in fair condition.

Recovered 0BT elm 16" (18") west (N86°W) 22 links, scribing grown over.

Description of monument and accessories I established to perpetuate the original location of this corner.

As the old cedar post is at the intersection of the N-S and E-W road and is in danger of being destroyed, a 1-1/2" O.D. x 24" pipe was set in its place. Set a 2-1/2" aluminum pipe with cast aluminum cap 30 links west of the true corner as a witness corner, stamped -

NBT - basswood 8" S33°E 93.3 links, scribed SC BT.

- S11 | S12 W.C.
- S14 | S13
- CPI-1975
- E-30 links
- S498
- T35N R11E

Dated at Rhineland, Wis., this 13th day of June, 1975

Signature *Phillip T. Hansen* Title Registered Land Surveyor Registration No. S-498
 (County Surveyor, Registered Land Surveyor, or other duly authorized official)

Office of Register of Deeds, County of Oneida
 Instrument was filed in this office for record on the 1st day of October, 1975
 at 3:00 o'clock P.M. I hereby certify that the within

By *Dora Verage Kuehn* (Register of Deeds)

By _____ Deputy

351110000