

CERTIFIED LAND CORNER RESTORATION

Index No. J-18

State of Wisconsin

County of Oneida } ss.

I Phillip T. Hansen, do hereby certify that on the 11th day of May, 1977, I found established the W 1/16 corner of Section 11 & 14

Township 35, North, Range 11 East, Fourth Principal Meridian, as described hereon; and that from this evidence I established a new monument and accessories as described hereon to perpetuate the original location of this corner.

Resident witnesses:

Clara Barker

Jim Martin

Herb Wagoner

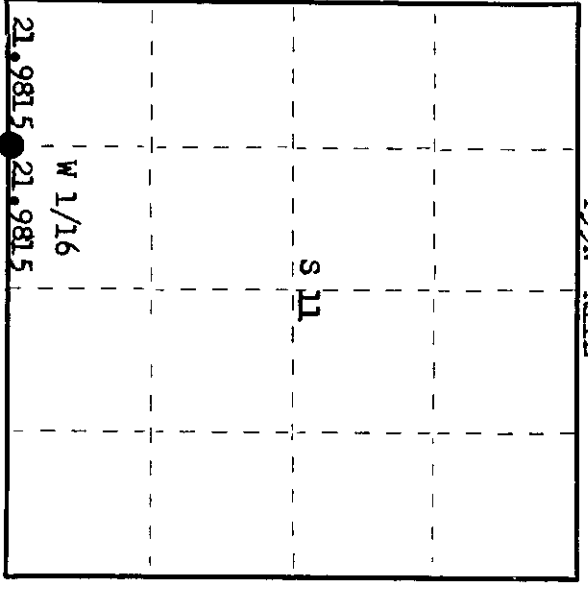
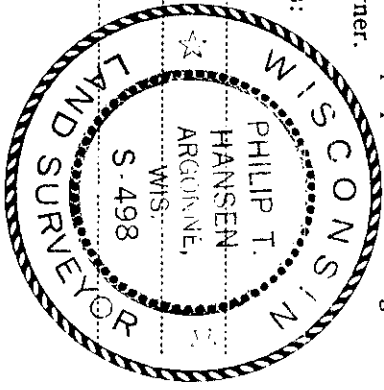

○ = Corner monument restored.

History of original corner establishment:

Corner re-established by traverse and computation to establish the SW 1/16 corner. This corner had been established by H.C. Lawrence, Registered Land Surveyor, in 1959. Computed distance between Section Corner 10, 11, 15, 14 and 1/4 corner between Section 11 and 14 at 4.3,963 chains. Re-set W 1/16 corner at 21,9815 chains equidistant on computed bearing S 88° 35' 51" E. This point falls 0.0565 chains (3.729 ft.) East of H.C. Lawrence's corner.

Description of corner evidence found:

Recovered 1 1/2" iron pipe with 2" brass cap set on October 13, 1976.

Description of monument and accessories I established to perpetuate the original location of this corner.

Reset 1 1/2" iron pipe to corrected position. Cap stamped:

Monument projects 18" above ground. S498
 Marked NBTs - White Spruce 10" S47°W, 1.183 chains, scribed 1/16 BT. T35N R11E
 White Spruce 16" S11°E, 1.242 chains, scribed 1/16 BT. W 1/16 S11
S14
CPI-1977

Dated at Rhineland, Wis., this 13th day of May, 1977.

Signature Phillip T. Hansen Title Registered Land Surveyor Registration No. S-498
 (County Surveyor, Registered Land Surveyor, or other duly authorized official)

Office of Register of Deeds, County of Oneida, I hereby certify that the within instrument was filed in this office for record on the 16th day of May, 1977 at 10:30 o'clock A.M.

Anna Verage Kusler
 (Register of Deeds)

By..... Deputy

35111 0030