

CERTIFIED LAND CORNER RESTORATION

Index No. H-21

State of Wisconsin

County of Oneida } ss.

I Phillip T. Hansen, do hereby certify that on the 8th day

established ~~by deed~~ June 1977, ~~1959~~

corner of Section 11 & 12

Township 35, North, Range

11 East, Fourth Principal Meridian,

as described hereon; and that from this evidence I established a new monument and accessories as described hereon to perpetuate the original location of this corner.

Resident witnesses:

Glen Barker

Jim Clafflin

Herb Wagoner

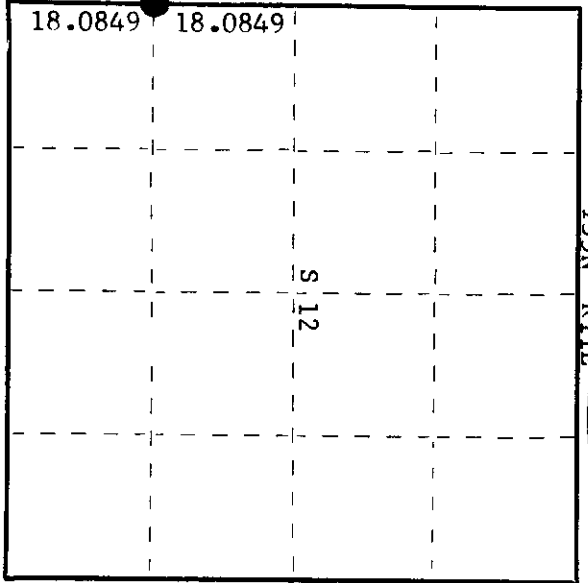
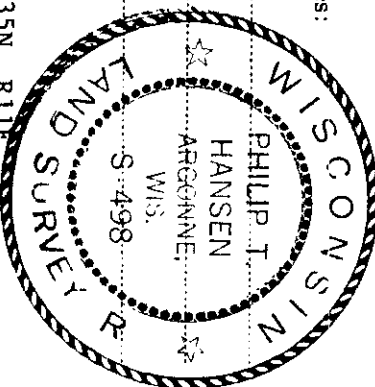

○ = Corner monument restored.

History of original corner establishment:  
Corner established by H.C. Lawrence, Registered Land Surveyor, in 1959. Set a 6" cedar post offset east of centerline of road. No reference made to any BTs established.

Description of corner evidence found:

No trace of Lawrence's cedar post in evidence.  
Established corner by proportion. Ran traverse from Section Corner 11, 12, 13 & 14 to 1/4 corner between Section 11 & 12. Computed distance 36.1698 at bearing N 6° 54' 55" E. Set S 1/16 at 18,0849 chains intermediate.

Description of monument and accessories I established to perpetuate the original location of this corner.  
Drove 1 1/2" x 15" iron pipe in east ditch line of town road 5" below the surface for true corner.

Set 1 1/2" iron pipe with brass cap for Witness Corner, 30 links east, stamped:  
Monument projects 18" above ground.  
As there were no suitable trees for BTs, set a 1 1/2" x 5' iron pipe 60 links west for witness pipe. Projects 36" above ground.

S 498  
T35N R11E  
S 1/16 S11|S12  
W - 30 lks  
CPI - 1977

Dated at Rhineland, Wis., this 9th day of June, 19 77.

Signature Phillip T. Hansen Title Registered Land Surveyor Registration No. S-498  
County Surveyor, Registered Land Surveyor, or other duly authorized official

Office of Register of Deeds, County of Oneida, I hereby certify that the within instrument was filed in this office for record on the 30th day of June, 19 77 at 9:20 o'clock A. M.

Doree Savage Truck  
(Register of Deeds)

By Joseph M. Boerner Deputy

351111000