

CERTIFIED LAND CORNER RESTORATION

Index No. H-18

State of Wisconsin }
County of Oneida } ss.

History of original corner establishment:
Corner established by traverse and computation, subdivision of SW 1/4 Section 11. Corner set at N 0° 07' 18" W, 19.657 chains from W 1/16 between Section 11 & 14 and S 87° 17' 18" E, 21.826 chains from S 1/16, Section 10 & 11.

I Phillip T. Hansen do hereby certify that on the 11th day of May 1977, I ~~was~~ was established of the SW 1/16 corner of Section 11 Township 35 North, Range 11 East, Fourth Principal Meridian, as described hereon; and that from this evidence I established a new monument and accessories as described hereon to perpetuate the original location of this corner.

Resident witnesses:

Glen Barker
Jim Clafin
Herb Wagoner

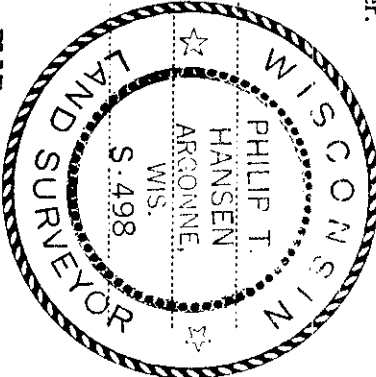

Description of monument and accessories I established to perpetuate the original location of this corner.
Set 1 1/2" iron pipe with 2" brass cap, stamped:
Monument projects 18" above ground.
Marked NBTs - White Birch 8" S64 E, 92.5 links.
White Birch 5" S26° E, 7.7 links.
Both BTs scribed 1/16 BT.
No other suitable BTs near.
S498
T35N R11E
SW 1/16 S11
CPI-1977

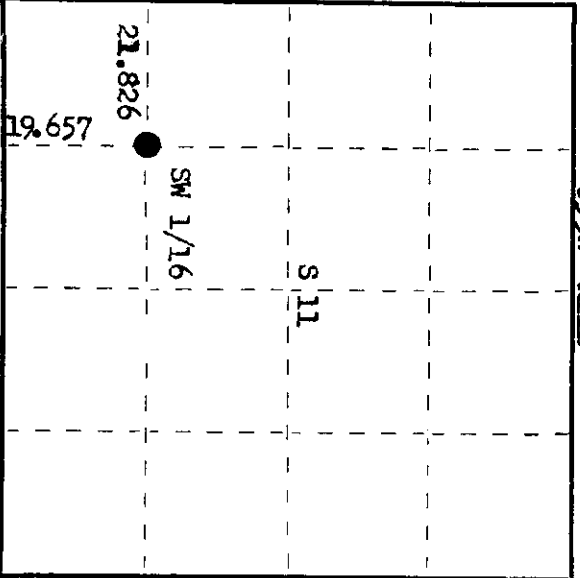

○ = Corner monument restored.

Description of corner evidence found:
No evidence of previous corner having been established.

Dated at Rhinelander, Wis., this 13th day of May, 1977.

Signature Phillip T. Hansen Title Registered Land Surveyor Registration No. S-498
(County Surveyor, Registered Land Surveyor, or other duly authorized official)

Office of Registrar of Deeds, County of Oneida, I hereby certify that the within instrument was filed in this office for record on the 16th day of May, 1977 at 10:30 o'clock A. M.

Anna Verage Tuckner
(Registrar of Deeds)

By _____ Deputy

351111030