

CERTIFIED LAND CORNER RESTORATION

Index No. 5-19

State of Wisconsin

County of Oneida } ss.

I Phillip T. Hansen, do hereby certify that on the 11th day of May, 1977, I ~~restored~~ re-established the C 1/4 corner of Section 11 Township 11 East, Range 35, North, Range 11 East, Fourth Principal Meridian, as described hereon; and that from this evidence I established a new monument and accessories as described hereon to perpetuate the original location of this corner.

History of original corner establishment:  
Corner established by traverse and computation from N 1/2 to S 1/4 and E 1/2 to W 1/2 corners. Established C 1/4 at 38.3287 chains N 0° 39' 25" W of S 1/4 corner and 43.3548 chains S 85° 57' 40" E of W 1/2 corner.

Description of corner evidence found:  
**No evidence of any corner found.**

Resident witnesses:

Glen Barker

Jim Clarlin

Herb Wagoner

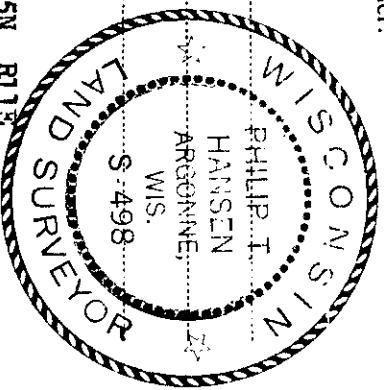

FORM 985

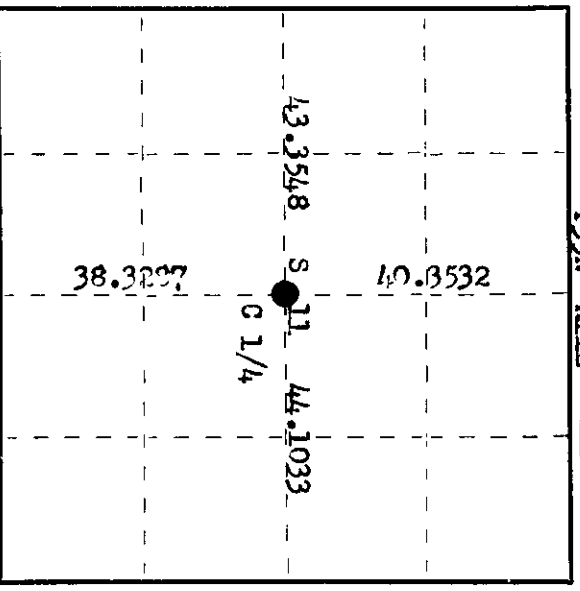

○ = Corner monument restored.

Dated at Rhinelander, Wis. this 13th day of May, 1977.

Signature Phillip T. Hansen Title Registered Land Surveyor Registration No. S-498  
(County Surveyor, Registered Land Surveyor, or other duly authorized official)

Office of Register of Deeds, County of Oneida. I hereby certify that the within instrument was filed in this office for record on the 16th day of May, 1977, at 30 o'clock a M.

Signature Doris George Kuehn  
(Register of Deeds)

By \_\_\_\_\_ Deputy

351112020