

CERTIFIED LAND CORNER RESTORATION

Index No. N-12

State of Wisconsin

County of Oneida } ss.

I Phillip T. Hansen, do hereby certify that on the 15th day of July, 1976, I found evidence of the W 1/16 corner of Section 16 and 21 Township 35 North, Range 11 East, Fourth Principal Meridian, as described hereon; and that from this evidence I established a new monument and accessories as described hereon to perpetuate the original location of this corner.

Resident witnesses:

Glen Barker

Jim Clarlin

Herb Magoner

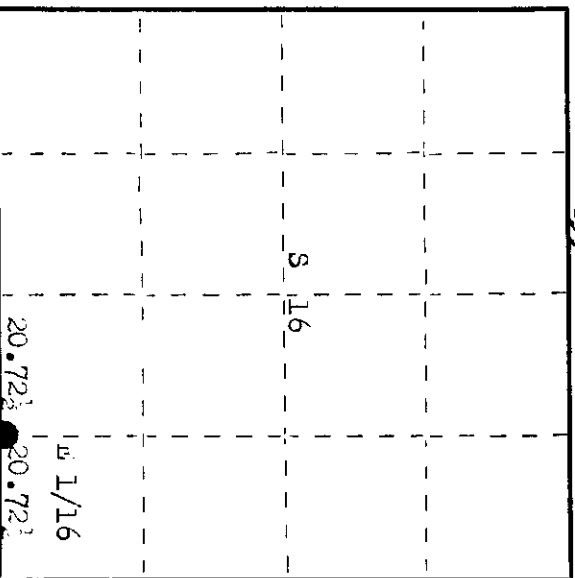
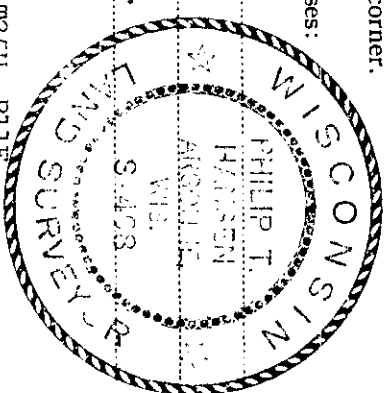

○ = Corner monument restored.

History of original corner establishment: Corner established by H.C. Lawrence, Registered Land Surveyor, in 1953. Ran a random line N 87° E from 1/4 corner in N-5 1/4 line road a distance of 41.45 chains to intersect with the 2.00 chains south of section corner S5, 16, 21 and 22.  
 Set W 1/16 corner 1.30 chains north at 20.72 chains equidistant.  
 Marked NBTs - Sugar 6" S 28° W 24 lks.  
 Maple 5" N 28° W 16 lks.  
 Found an old 1/16 corner 1.22 chains North and 1.00 chain west of new corner.

Description of corner evidence found:

Recovered a 9" cedar post, squared and scribed W 1/16 S 10, S 1/16 S 21 in fair condition.  
 Recovered NBTs - Maple 5" (6") N 28° " 16.5 lks, top scribing rotted out.  
 Sugar 6" (9") S 28° " 24 lks, scribing grown over.

Description of monument and accessories I established to perpetuate the original location of this corner.

Replaced wood post with 1 1/2" iron pipe with 2" brass cap stamped.  
 Monument projects 24" above ground.  
 NBT - Sugar 12" N 68° " 13.2 lks, scribed 1/16 BT.  
 Corner sets approximately 2.5 chains south of old W 1/16 logging road.  
 T35N H11E  
 S 1/16 S 16  
 S 1/21  
 CPI-1976

Dated at Orineland, Wis., this 19th day of August, 1976.

Signature Phillip T. Hansen Title Registered Land Surveyor Registration No. 3498  
 (County Surveyor, Registered Land Surveyor, or other duly authorized official)

Office of Register of Deeds, County of Oneida  
 Instrument was filed in this office for record on the 22nd day of September, 1976  
 at 10:00 o'clock M.

Doree Terage Fieker  
 (Register of Deeds)

By: \_\_\_\_\_ Deputy

351160010