

CERTIFIED LAND CORNER RESTORATION

Index No. N-10

State of Wisconsin

County of Oneida

} ss.

I Phillip T. Hansen, do hereby certify that on the 8th day of May, 1978, I ~~found~~ **established** the W 1/16 corner of Section 16 & 21 Township 35 North, Range 11 East, Fourth Principal Meridian,

as described hereon; and that from this evidence I established a new monument and accessories as described hereon to perpetuate the original location of this corner.

Resident witnesses:

Glen Barker

Jim Claflin

Herb Wagoner

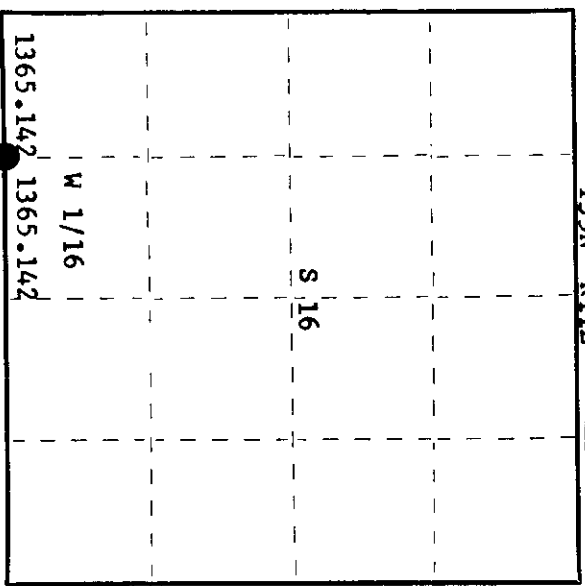
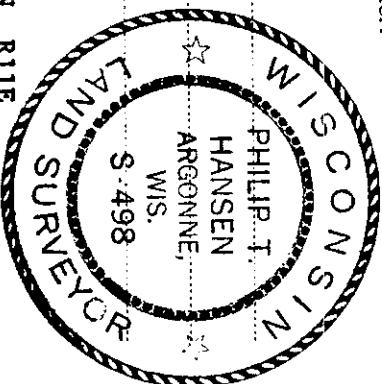

○ = Corner monument restored.

History of original corner establishment:

No evidence of any corner found.

Description of corner evidence found:

Corner established by traverse and computation. Set corner at 1365.142 feet intermediate between previously established 1/4 corner section 16 & 21 and section corner 16, 17, 20 & 21 at bearing S 88° 26' 09" W.

Description of monument and accessories I established to perpetuate the original location of this corner.

Set a 1 1/2" iron pipe with 2" brass cap for corner. Cap stamped:

NBT's - S498
Maple 6" S89°E, 46.18 feet T35N R11E
White Birch 8" N10°E, 20.5 feet W 1/16 S 16
scribed 1/16 BT CPI-1978

Dated at Rhineland, Wis., this 19th day of May, 1978

Signature: Phillip T. Hansen Title Registered Land Surveyor Registration No. S-498
(County Surveyor, Registered Land Surveyor, or other duly authorized official)

Office of Registrar of Deeds, County of Oneida
Instrument was filed in this office for record on the 3rd day of May, 1978
at 100 o'clock P. M. I hereby certify that the within

Doris George Fischer
(Registrar of Deeds)

By _____ Deputy

351116 0030