

CERTIFIED LAND CORNER RESTORATION

Index No. **M-13**

State of Wisconsin

County of Oneida } ss.

I Phillip T. Hansen, do hereby certify that on the 15th day of August, 1976, I found evidence of the S 1/16 corner of section 15 and 16 Township 35 North, Range 11 East, Fourth Principal Meridian, as described hereon; and that from this evidence I established a new monument and accessories as described hereon to perpetuate the original location of this corner.

Resident witnesses:
 Glen Barker
 Jim Clafflin
 Herb Wagoner

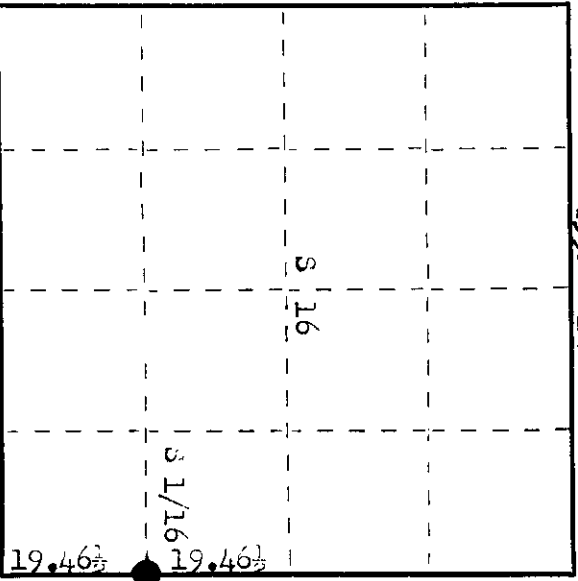
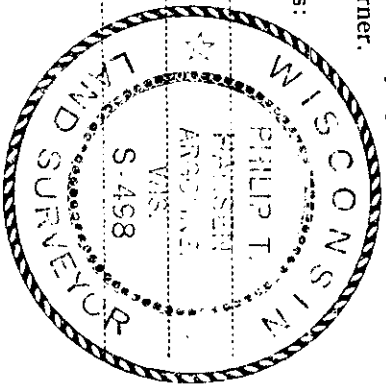

○ = Corner monument restored.

History of original corner establishment: Corner established by H.C. Lawrence, registered Land Surveyor, in 1953. Ran random line south from recovered section Corner 9, 10, 15, 16 77.36 chains closing out 22 lks west of section Corner 15, 16, 21, 22, previously established. Set S 1/16 Corner at 19.46 1/2 chs North, 17 lks East equidistant between section Corner and re-established 1/4 Corner. Set 4" cedar post. No BTs marked.

Description of corner evidence found:
 Recovered 4" cedar post, squared and scribed S15, S 1/16 S16 in very poor condition.
 No BTs recovered.

Description of monument and accessories I established to perpetuate the original location of this corner.
 Extracted the post and replaced it with 1 1/2" iron pipe with 2" brass cap stamped.
 Monument projects 36" above ground.
 Corner sets 4 chains west of west edge of old river rice beds.
 NBT - Black ash 12" N 79° .. 56 lks, scribed 1/16 BT.
 Black ash 8" S 10° E 39.8 lks, scribed 1/16 BT.
 Monument and BTs painted blue.
 S498
 T35N R11E
 S 1/16 16 15
 CPI-1976

Dated at Rhinelander, Wis., this 15th day of August, 1976

Signature: *Phillip T. Hansen* Title: Registered Land Surveyor Registration No. 3-498
 (County Surveyor, Registered Land Surveyor, or other duly authorized official)

Office of Register of Deeds, County of Oneida
 Instrument was filed in this office for record on the 22nd day of August, 1976 at 10:00 o'clock P.M.
Lorrie Savage Register of Deeds
Frederick

By: _____ Deputy

351161000