

CERTIFIED LAND CORNER RESTORATION

Index No. M-11

State of Wisconsin

County of Oneida } ss.

I Philip T. Hansen, do hereby certify that on the 9th day of May, 1978, I ~~found~~ **established** the SC 1/16 corner of Section 16 Township 35, North, Range 11 East, Fourth Principal Meridian,

as described hereon; and that from this evidence I established a new monument and accessories as described hereon to perpetuate the original location of this corner.

Resident witnesses:

- Glen Barker
- Jim Clafflin
- Herb Wagoner

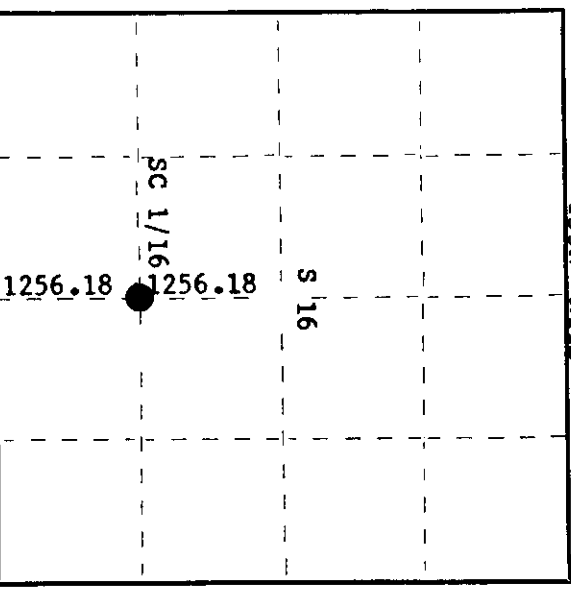
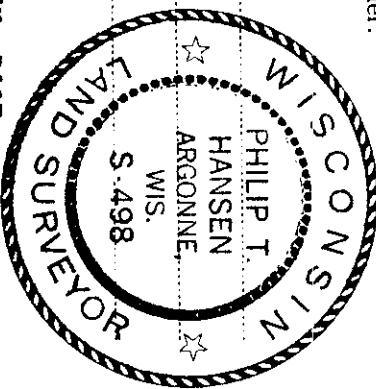

○ = Corner monument restored.

History of original corner establishment:

**No evidence of any corner found.**

Description of corner evidence found:

**Corner established by subdivision from traverse computation. From S 1/4 corner to previously established C 1/4 corner. Computed distance is 2512.364 feet at bearing N 2° 38' 37" W. Set SC 1/16 at 1256.18 feet intermediate.**

Description of monument and accessories I established to perpetuate the original location of this corner.

- Set a 1 1/2" iron pipe with 2" brass cap for corner, cap stamped: S498
- Pipe projects 24" above ground. T35N R11E
- Corner sets 40 feet west of Stockley Meister Road. SC 1/16 S 16
- Marked NBT's - CPI-1978
- Maple 8" S20°E, 10.05 feet
- Maple 5" N66°W, 42.7 feet
- scribed 1/16 BT.

Dated at Rhinelander, Wis., this 19th day of May, 1978.

Signature Philip T. Hansen Title Registered Land Surveyor Registration No. S-498  
(County Surveyor, Registered Land Surveyor, or other duly authorized official)

Office of Registrar of Deeds, County of Oneida. I hereby certify that the within instrument was filed in this office for record on the 22nd day of May, 1978 at 10:00 o'clock M.

Doris Lorange Furbush  
(Registrar of Deeds)

By \_\_\_\_\_ Deputy

3511161020