

CERTIFIED LAND CORNER RESTORATION

Index No. L-13

State of Wisconsin

County of Oneida } ss.

I Phillip F. Hansen, do hereby certify that on the 15th day of July, 1976, I found evidence of the quarter corner of section 15 and 16 Township 35 North, Range 11 East, Fourth Principal Meridian, as described hereon; and that from this evidence I established a new monument and accessories as described hereon to perpetuate the original location of this corner.

Resident witnesses:

Glen Barker

Jim Claflin

Herb Wagoner

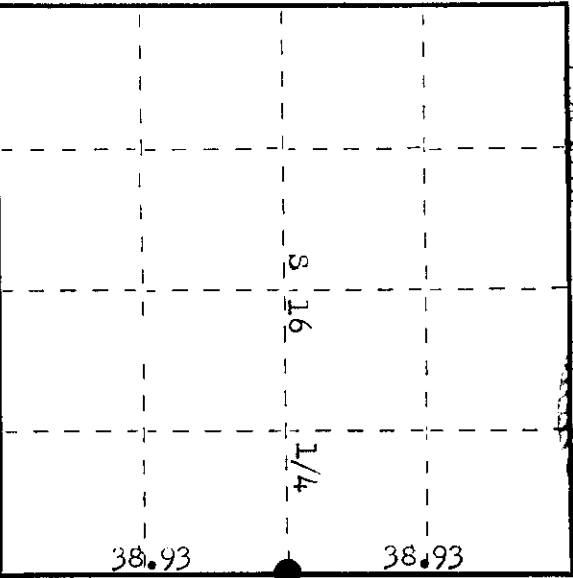
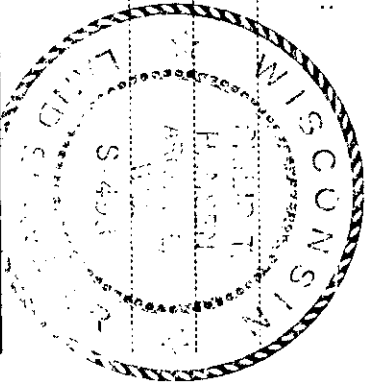

○ = Corner monument restored.

History of original corner establishment: Original Corner established by Wm. W. Dougherty, Deputy Surveyor, in 1859, from which Tamarack 12" bears 52° .. 50 lks. no other trees near. Corner re-established by H.C. Lawrence, Registered Land Surveyor, in 1953. ran random line south from recovered section Corner 9, 10, 15 and 19, 77.86 chs closing out 22 lks west of section Corner 15, 16, 21, 22, previously established. Set C 1/4 11 lks east of 58.93 chains equidistant. No BFs marked.

Description of corner evidence found:

Recovered 4" cedar post, squared and scribed 1/4 S 15, 1/4 S 16, in poor condition.

No evidence of any BFs recovered.

Description of monument and accessories I established to perpetuate the original location of this corner.

Extracted the wood post from muck and replaced it with 2 1/2" Bernsten #1 Federal Monument projecting 18" above ground.

Drove support stakes beside aluminum post, set old post beside it. Cap stamped.

Monument projects 18" above ground.

Corner sets on west side of Wolf River in large willow marsh.

No BFs available.

Set 2 witness monument - #1 - 1 1/2" iron pipe with brass cap,

stamped S-498 S 20 lks 1/4 W.C. CPI-1976, projects 18".

#2 - 1 1/2" iron pipe with brass cap, stamped S-498 - S - 15 lks

1/4 W.C. CPI-1976. "C. projects 18" above ground.

T35N R11E
1/4 C 16 15
S498-1976

Dated at Whitelander, Wis. this 18th day of August, 1976

Signature: Phillip F. Hansen Title: Registered Land Surveyor Registration No. S-498
(County Surveyor, Registered Land Surveyor, or other duly authorized official)

Office of Register of Deeds, County of Oneida, I hereby certify that the within instrument was filed in this office for record on the 22nd day of September, 1976 at 10:00 o'clock P. M.

Donna Veraga Brecht
(Register of Deeds)

By: _____ Deputy

351162000