

CERTIFIED LAND CORNER RESTORATION

Index No. L-11

State of Wisconsin } ss.  
County of Oneida

I Phillip T. Hansen, do hereby certify that on the 9th day of May, 1978, I ~~restored~~ established the C 1/4 corner of Section 16 Township 35, North, Range 11 East, Fourth Principal Meridian,

as described hereon; and that from this evidence I established a new monument and accessories as described hereon to perpetuate the original location of this corner.

Resident witnesses:  
Glen Barker  
Jim Clafflin  
Herb Wagoner

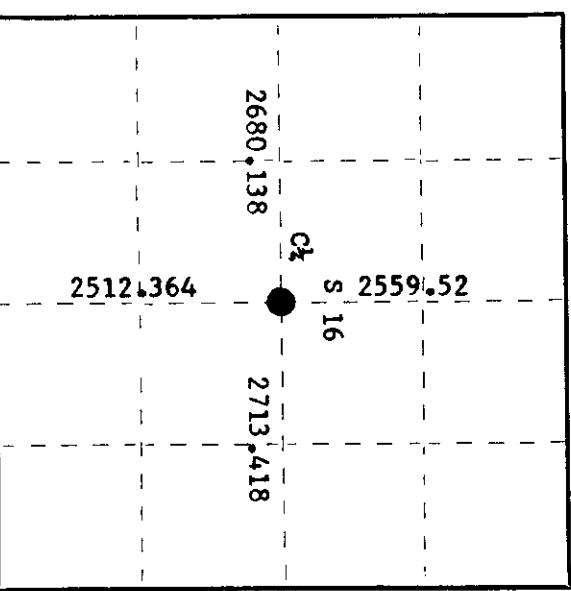
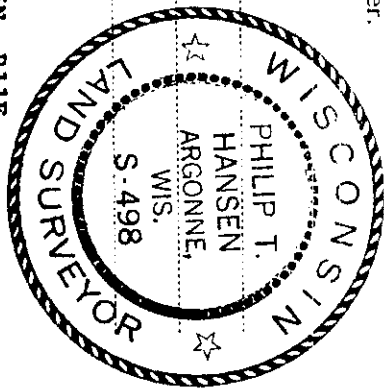

○ = Corner monument restored.

History of original corner establishment:  
**No evidence of any corner found.**

Description of corner evidence found: Corner established by traverse and computation. Ran traverse from N 1/4 corner to S 1/4 corner, section 16. Ran traverse from E 1/4 corner to W 1/4 corner, section 16 to established C 1/4 corner.  
Corner sets 2559.52 feet S2° 38' 37" E of N 1/4 corner  
Corner sets 2512.364 feet N2° 38' 37" W of S 1/4 corner  
Corner sets 2680.138 feet N89° 10' 45" E of W 1/4 corner  
Corner sets 2713.418 feet S89° 10' 45" W of E 1/4 corner

Description of monument and accessories I established to perpetuate the original location of this corner.  
Set a 2 1/2" Oneida County Iron pipe with brass cap, stamped:  
Projects 24" above ground.  
Corner sets 27 feet west of Stockley Melster Road.  
Marked NBT's -

- Tamarack 12" N89°W, 23.33 feet
  - Tamarack 10" N63°W, 47.63 feet
  - Tamarack 12" S40°W, 48.52 feet
  - Tamarack 10" S88°E, 81.12 feet
- all scribed C 1/4 BT

Dated at Rhinelander, Wis., this 19th day of May, 1978

Signature Phillip T. Hansen Title Registered Land Surveyor Registration No. S-498  
(County Surveyor, Registered Land Surveyor, or other duly authorized official)

Office of Register of Deeds, County of Oneida. I hereby certify that the within instrument was filed in this office for record on the 22nd day of May, 1978 at 100 o'clock P. M.

Terrie Verge Kuehn  
(Register of Deeds)

By: \_\_\_\_\_ Deputy

351162020