

CERTIFIED LAND CORNER RESTORATION

Index No. **K-11**

State of Wisconsin

County of Oneida } ss.

I Phillip T. Hansen, do hereby certify that on the 9th day of May, 19 78, I ~~restored~~ **established** the NC 1/16 corner of Section 16

Township 35, North, Range 11 East, Fourth Principal Meridian,

as described hereon; and that from this evidence I established a new monument and accessories as described hereon to perpetuate the original location of this corner.

Resident witnesses:

Glen Barker

Jim Claflin

Herb Wagoner

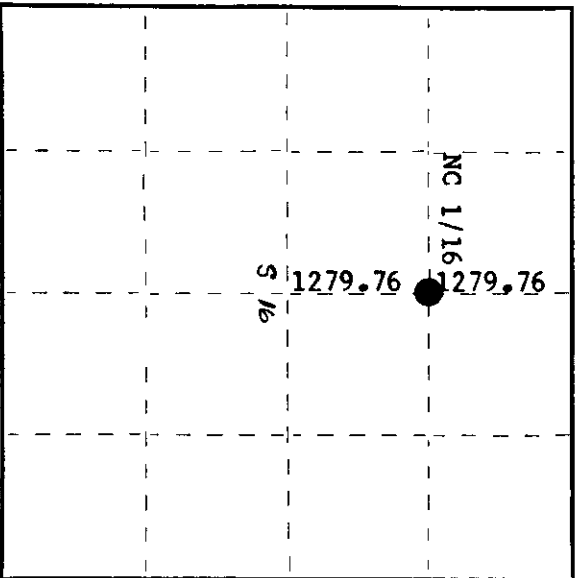
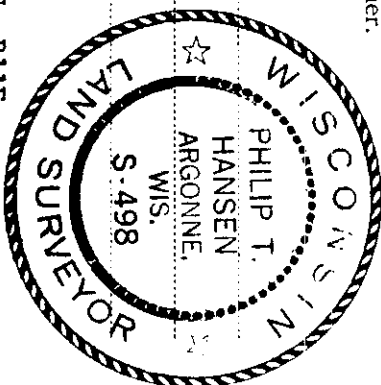

History of original corner establishment:
No evidence of any corner found.

Description of corner evidence found:
Corner established by subdivision from traverse computation from N 1/4 corner to previously established C 1/4 corner. Computed distance is 2559.52 feet at bearing N 2° 38' 37" W. Set NC 1/16 at 1279.76 feet intermediate.

Description of monument and accessories I established to perpetuate the original location of this corner.
Drove a **1 1/2" x 18"** iron pipe in east shoulder of Stockley Meister Road for true corner, 5" below surface.
Set a **1 1/2"** iron pipe with 2" brass cap 30 feet east for witness corner. Cap stamped:
Pipe projects 20" above ground. **S498**
Marked NBT's to true corner - **T35N R11E**
Maple 5" N46°E, 28.83 feet **NC 1/16 S 1/4 W.C.**
Maple 9" S46°E, 47.75 feet **W. 30 Ft.**
CPI-1978

Dated at Rhinelander, Wis., this 19th day of May, 19 78

Signature: Phillip T. Hansen Title: **Registered Land Surveyor** Registration No. **S-498**
(County Surveyor, Registered Land Surveyor, or other duly authorized official)

Office of Register of Deeds, County of Oneida, I hereby certify that the within instrument was filed in this office for record on the 22nd day of May, 19 78 at 100 o'clock P. M.

Doree George Fischer
(Register of Deeds)

○ = Corner monument restored.

By: _____ Deputy

351116 3020