

CERTIFIED LAND CORNER RESTORATION

Index No. M-9

State of Wisconsin } ss.
County of Oneida

I Phillip T. Hansen, do hereby certify that on the 8th day of May, 1978, I found established ~~marked~~ the S 1/16 corner of Section 16 & 17 Township 35, North, Range 11 East, Fourth Principal Meridian,

as described hereon; and that from this evidence I established a new monument and accessories as described hereon to perpetuate the original location of this corner.

Resident witnesses:
Glen Barker
Jim Clafflin
Herb Wagoner

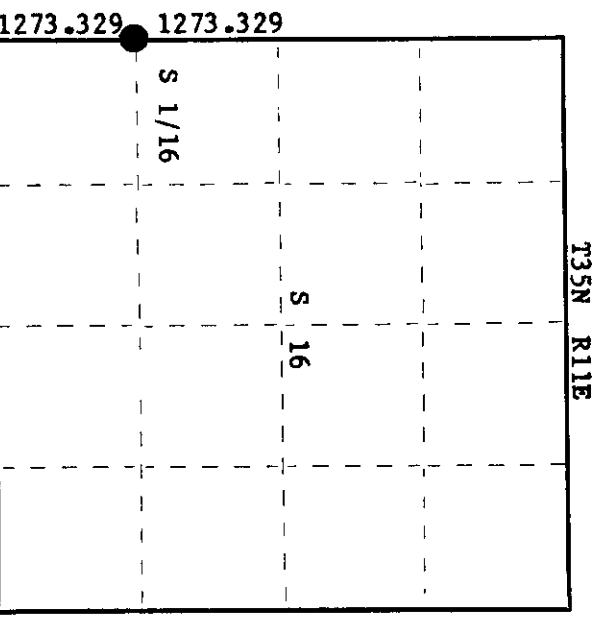
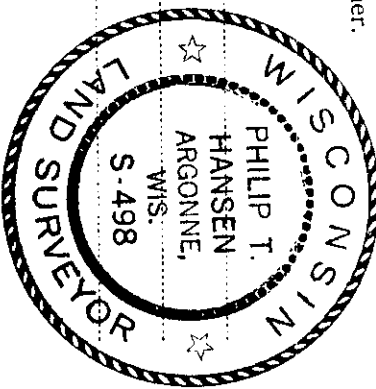

○ = Corner monument restored.

History of original corner establishment:
No evidence of any corner found.

Description of corner evidence found:

Corner established by traverse and computation. Set corner at 1273.329 feet intermediate between 1/4 corner between section 16 & 17, and section corner 16, 17, 20 and 21 at bearing N 1° 29' 45" W.

Description of monument and accessories I established to perpetuate the original location of this corner.

Set 1 1/2" iron pipe with 2" brass cap for corner. Cap stamped:

Pipe projects 24" above ground.
S498
T35N R11E
NBT's - Black Spruce 6" S 74° W, 7.7 feet
Black Spruce 8" N 33° W, 48.4 feet
scribed 1/16 BT
S 1/16 17 1/16
CPI-1978

Dated at Rhineland, Wis., this 19th day of May, 1978

Signature Phillip T. Hansen Title Registered Land Surveyor Registration No. S-498
(County Surveyor, Registered Land Surveyor, or other duly authorized official)

Office of Register of Deeds, County of Oneida
Instrument was filed in this office for record on the 22nd day of May, 1978
at 1:00 o'clock P. M. I hereby certify that the within

Doris Savage Fuchs
(Register of Deeds)

By _____ Deputy

3511171000