

CERTIFIED LAND CORNER RESTORATION

Index No. 0-9

State of Wisconsin }
 County of Oneida } ss.

History of original corner establishment:
No evidence of any corner found.

I, Phillip T. Hansen, do hereby certify that on the 9th day of June, 19 78, I ~~found~~ ^{established} ~~corner~~ of the N 1/16 corner of sections 20 & 21

Township 35, North, Range 11 East, Fourth Principal Meridian, as described hereon; and that from this evidence I established a new monument and accessories as described hereon to perpetuate the original location of this corner.

Description of corner evidence found:
Corner established by traverse and computation.
Set corner at 1253.30 feet intermediate between 1/4 section corner 20 & 21 and section corner 16, 17, 20 & 21 at bearing N 1° 04' 43" W.

Resident witnesses:

Glen Barker

Jim Clafflin

Herb Wagoner

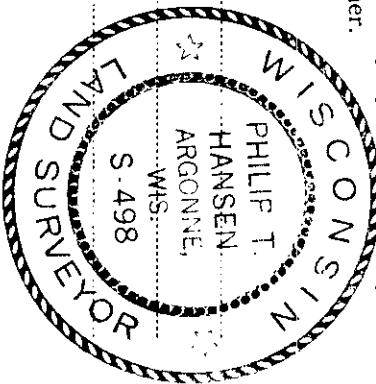

Description of monument and accessories I established to perpetuate the original location of this corner.
Set a 1 1/2" iron pipe with 2" brass cap, stamped:
Pipe projects 24" above ground.
Marked NBT's -
Maple 6" N34°W, 26.50 feet
Black Spruce 6" S4°E, 44.97 feet
scribed 1/16 BT.

S498
 T35N R11E
 20 + 21
 N 1/16
 GPI 1978

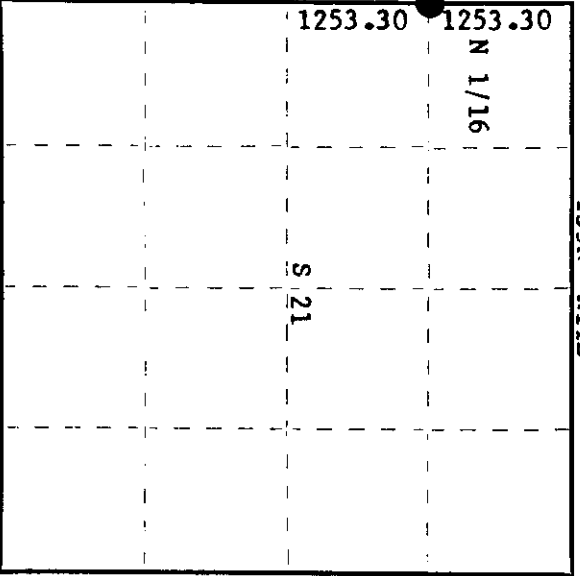

○ = Corner monument restored.

Dated at Rhineland, Wis., this 10th day of July, 19 78

Signature Phillip T. Hansen Title Registered Land Surveyor Registration No. S-498
 (County Surveyor, Registered Land Surveyor, or other duly authorized official)

Office of Register of Deeds, County of Oneida
 at 10:00 o'clock A. M. July day of July, 19 78
 I hereby certify that the within

Doris Savage Kuehn
 (Register of Deeds)

By: _____ Deputy