

CERTIFIED LAND CORNER RESTORATION

Index No. R-11

State of Wisconsin } ss.  
 County of Oneida

I Phillip T. Hansen, do hereby  
 certify that on the 22nd day  
 of May, 19 78, I found

~~established~~ the Quarter  
~~corner of~~ Section 21 & 28  
 Township 35, North, Range

11 East, Fourth Principal Meridian,  
 as described hereon; and that from this evidence  
 I established a new monument and accessories  
 as described hereon to perpetuate the original  
 location of this corner.

Resident witnesses:  
Glen Barker  
Jim Claflin  
Herb Wagoner

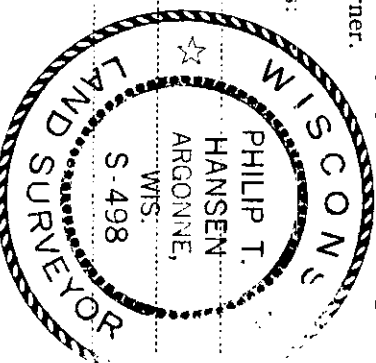

History of original corner establishment:  
 Original corner established by Wm. E. Dougherty, Deputy Surveyor, in 1859 from which  
 white birch 8" bears N 42° E, 11 links and white birch 10" bears S 54° W, 6 links.  
 No records of any subsequent survey.

Description of corner evidence found:  
 No evidence of any 1/4 corner recovered.  
 Corner established and computed by traverse and computation. Ran traverse from previously  
 established and recovered section corner 21, 22, 27 and 28 to section corner 20, 21,  
 28 & 29. Computed distance 5277.354 feet at bearing N 88° 01' 13" West.  
 Set 1/4 corner at 2638.677 feet intermediate.

Description of monument and accessories I established to perpetuate the original location of this corner.  
 Set a 2 1/2" Bernitsen A-1 Federal Monument (O.C.) projecting 10" above ground. Cap stamped:

Marked NBT's -  
 Sugar 7" S83°E, 24.75 feet S498  
 Maple 7" S23°W, 18.12 feet T35N R11E  
 Sugar 7" S83°W, 37.70 feet 1/4 S 21  
 Maple 6" N7°W, 14.75 feet S 28  
 all scribed 1/4 BT 1978

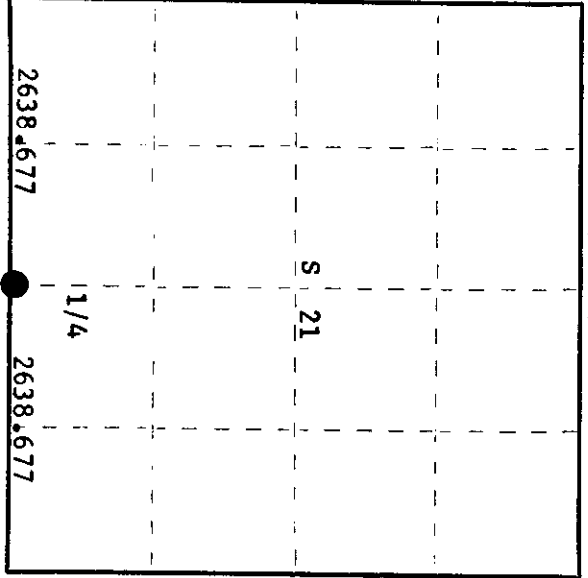

○ = Corner monument restored.

Dated at Rhineland, Wis., this 5th day of June, 19 78.

Signature Phillip T. Hansen Title Registered Land Surveyor Registration No. S-498  
 (County Surveyor, Registered Land Surveyor, or other duly authorized official)

Office of Register of Deeds, County of Oneida  
 Instrument was filed in this office for record on the 13th day of June, 19 78.  
 at 2:30 o'clock P. M. I hereby certify that the within

By Joseph M. Berman Deputy  
David Wayne Kuehn  
 (Register of Deeds)

351121020