

CERTIFIED LAND CORNER RESTORATION

Index No. **Q-10**

State of Wisconsin }  
 County of Oneida } ss.

History of original corner establishment:  
**No records of any previous survey.**

I Phillip T. Hansen, do hereby certify that on the 28th day of June, 1978, I ~~restored~~ **established** ~~restored~~ the SW 1/16 corner of Section 21 Township 35, North, Range 11 East, Fourth Principal Meridian,

as described hereon; and that from this evidence I established a new monument and accessories as described hereon to perpetuate the original location of this corner.

Resident witnesses:

Glen Barker  
Jim Clafflin  
Herb Wagoner  
John Masbaum

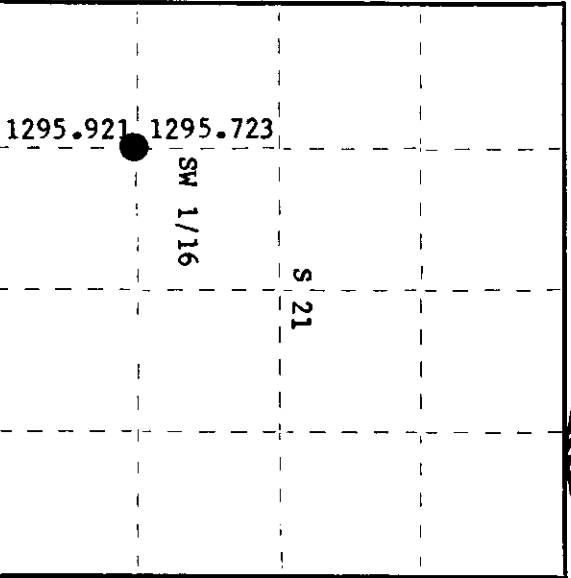
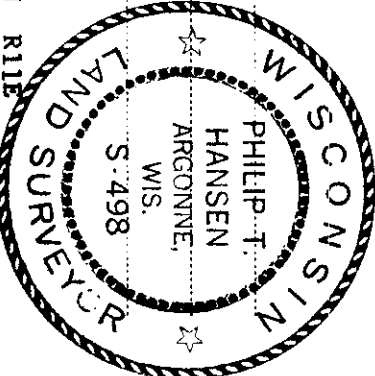

○ = Corner monument restored.

Description of corner evidence found:

**No evidence of any corner recovered.** Corner established by traverse and computation. From previously established W.C. 1/16 and W 1/16 between section 21 and section 28, computed distance is 2534.335 feet N 0° 32' 44" W. Computed location of SW 1/16 is 1267.47 feet N 0° 32' 44" W of E 1/16 corner and 1266.865 feet S 0° 32' 44" E of WC 1/16.

Description of monument and accessories I established to perpetuate the original location of this corner.

Set a 1 1/2" iron pipe with 2" brass cap, stamped:  
 Monument projects 26" above ground.  
 Marked NBT's -  
 Maple 5" N80°W, 3.68 feet S498  
 Maple 6" N34°E, 3.98 feet, scribed 1/16 BT T35N R11E  
SW 1/16 S 21  
CPI-1978

Dated at Rhineland, Wis., this 5th day of July, 1978

Signature Phillip T. Hansen Title Registered Land Surveyor Registration No. S-498  
 (County Surveyor, Registered Land Surveyor, or other duly authorized official)

Office of Register of Deeds, County of Oneida  
 Instrument was filed in this office for record on the 14th day of August, 1978  
 at 10:45 o'clock P. M.

Doris Savage Kuehn  
 (Register of Deeds)

By: \_\_\_\_\_ Deputy

3511211030