

CERTIFIED LAND CORNER RESTORATION

Index No. V-24

State of Wisconsin }
County of Oneida } ss.

I Phillip T. Hansen do hereby
certify that on the 16th day
of November, 19 76, I found
evidence of the E 1/16
corner of Section 25 & 36
Township 35 North, Range
11 East, Fourth Principal Meridian,

as described hereon; and that from this evidence
I established a new monument and accessories
as described hereon to perpetuate the original
location of this corner.

Resident witnesses:

Glen Barker

Jim Carlton

Herb Wagoner

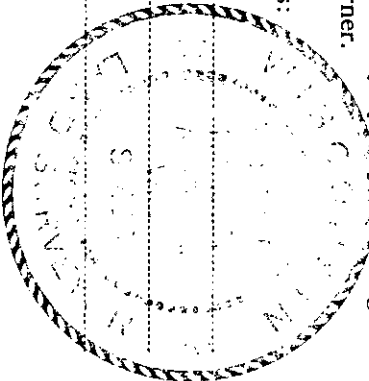

T35N R11E

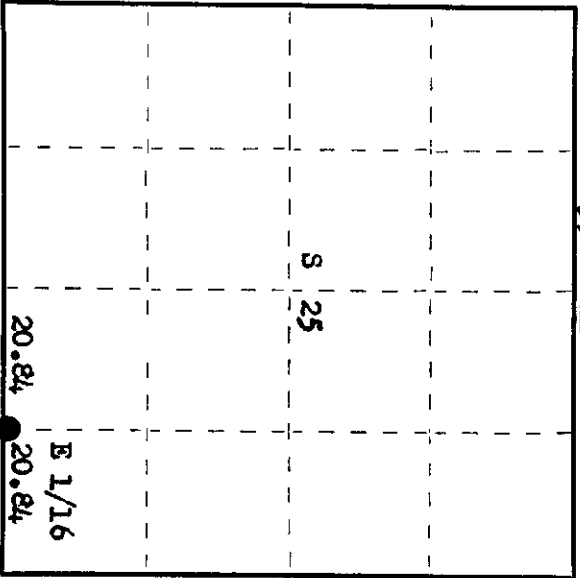

○ = Corner monument restored.

History of original corner establishment:

Corner established by H.C. Lawrence, Registered Land Surveyor, in 1958.
Ran random line east from restored 1/4 corner 41.68 chains to corner on range line
which point is 3.00 chains south of Section Corner 25, 30, 31 and 36.
Set 4" cedar post equidistant at 20.84 chains and 1.50 chains north.
Marked MBTs - Hemlock 10" S 60° E 44 1/2 links, Maple 14" N 80° W 11 1/2 links.

Description of corner evidence found:

Recovered 4" cedar post, squared and scribed E 1/16 S25, E 1/16 S36, in poor condition.
Recovered MBTs - Hemlock 10" (12") S 64° E 44.5 links, scribed S36 BT.
Maple 14" N 80° W (N 74° W) 11.5 links (12.5 links) scribed E 1/16 BT (dead).

Description of monument and accessories I established to perpetuate the original location of this corner.

Replaced post with 1 1/2" OD iron pipe with brass cap stamped:
Monument projects 24" above ground.
MBT - Sugar 10" S 45° W 29.8 links, scribed 1/16 BT.

S4,98
T35N R11E
E 1/16 S 25
S 36
CPI-1976

Dated at Rhinelander, Wis., this 3rd day of December, 19 76
Signature: Phillip T. Hansen Title: Registered Land Surveyor Registration No. S-498
(County Surveyor, Registered Land Surveyor, or other duly authorized official)

Office of Register of Deeds, County of Oneida
Instrument was filed in this office for record on the 20th day of December, 19 76
at 1:00 o'clock P. M.

Devin W. Wagner Kushka
(Register of Deeds)

By: _____ Deputy

251250010