

CERTIFIED LAND CORNER RESTORATION

Index No. **V-18**

State of Wisconsin

County of Oneida

ss.

I Phillip T. Hansen, do hereby

certify that on the 18th day

of January, 1977, I found

evidence of the W 1/16

corner of Section 26 & 35

Township 35, North, Range

11 East, Fourth Principal Meridian,

as described hereon; and that from this evidence

I established a new monument and accessories

as described hereon to perpetuate the original

location of this corner.

Resident witnesses:

Glen Barker

Jim Claflin

Herb Wagoner

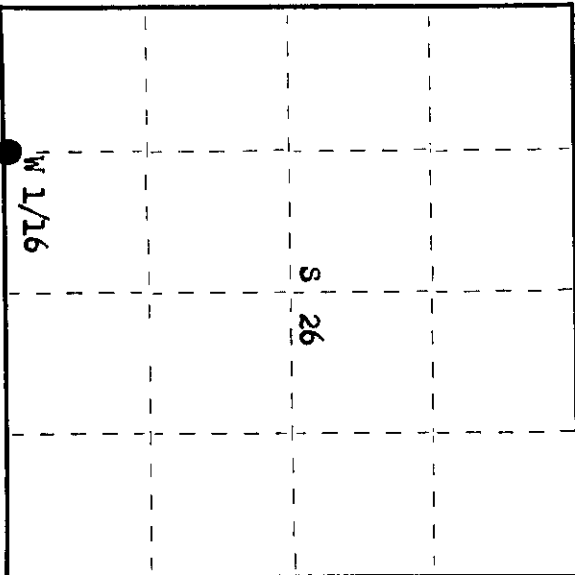
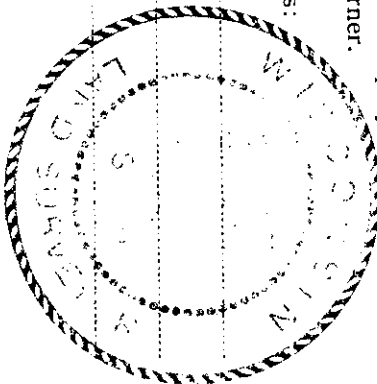

○ = Corner monument restored.

History of original corner establishment:

Corner established by D.H. Vaughan, County Surveyor, in 1914. Set post and marked BT - Norway Pine 18" N 47° W 12 links.

Corner recovered by H.C. Lawrence, Registered Land Surveyor, in 1949. Set new tamarack post and marked NBT - Oak 18" S 27° E 66 links.

Description of corner evidence found:

Recovered 4" tamarack post, squared and scribed W 1/16 S26, W 1/16 S35, with rock cairn around base. Post was in very poor condition.

Recovered OBTS - Red Pine 18" (24") N 47° W 12 links (12.5 links) scribed W 1/16 S26. Oak 20" S 27° E 66 links, scribing grown over.

Description of monument and accessories I established to perpetuate the original location of this corner.

Replaced tamarack post with 1 1/2" OD iron pipe with brass cap, stamped:

Monument projects 24" above ground. NBT - White Pine 7" S 33° W 45.5 links, scribed 1/16 BT. Corner sets in an old E-W fence line.

S498
T35N R11E
W 1/16 S 26 | S 35
CPL-1977

Dated at Rhinelander, Wis., this 24th day of January, 1977

Signature Phillip T. Hansen Title Registered Land Surveyor Registration No. S-498
(County Surveyor, Registered Land Surveyor, or other duly authorized official)

Office of Register of Deeds, County of Oneida at 1:00 o'clock P. M. 24th day of January, 1977.
I hereby certify that the within instrument was filed in this office for record on the 24th day of January, 1977.

Doris Savage Fischer
(Register of Deeds)

By: _____ Deputy

3511260030