

CERTIFIED LAND CORNER RESTORATION

Index No. U-16

State of Wisconsin

County of Oneida } ss.

I Phillip T. Hansen, do hereby

certify that on the 22nd day

of the February, 1979, I found

~~restored~~ restored the SE 1/16

corner of Section 27

Township 35, North, Range

11 East, Fourth Principal Meridian,

as described hereon; and that from this evidence I established a new monument and accessories as described hereon to perpetuate the original location of this corner.

Resident witnesses:

Glen Barker

Jim Claflin

Herb Wagoner

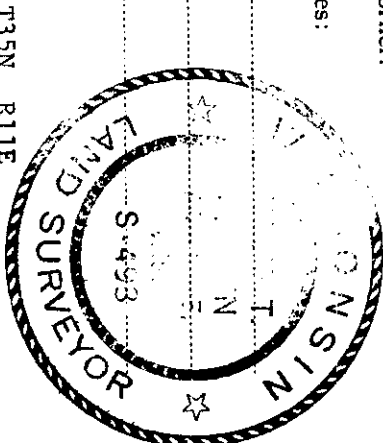

T35N R11E

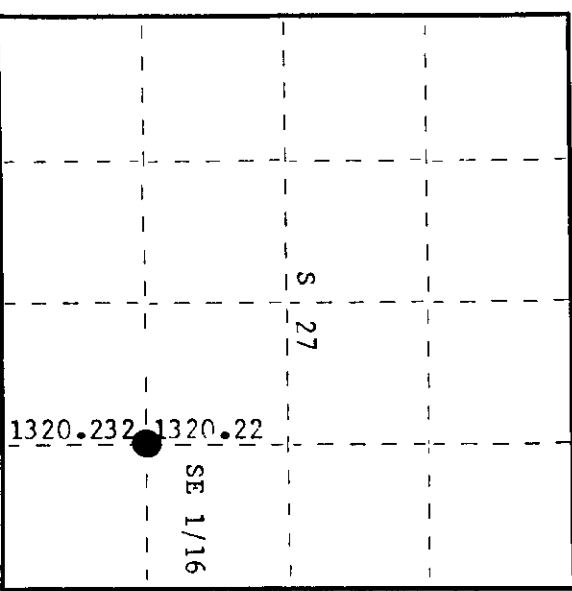

○ = Corner monument restored.

History of original corner establishment:

No records of any previous survey.

Description of corner evidence found:

No evidence of any corner recovered.

Corner established by traverse and computation. Computed distance from E 1/16 sections 27 and 34 to EC 1/16 is 2640.452' at bearing N 0° 51' 16" E. Computed location of SE 1/16 corner is 1320.232' N 0° 51' 16" E of E 1/16 and 1320.22' S 0° 51' 16" W of EC 1/16.

Description of monument and accessories I established to perpetuate the original location of this corner.

Set a 1 1/2" iron pipe with 2" brass cap, stamped:

Monument projects 18" above ground.

Marked NBT's -

White Pine 7" S84°W 42.85 feet, scribed 1/16 BT.

Red Pine 7" S32°W 32.90 feet, scribed 1/16 BT.

S498
T35N R11E
SE 1/16 S+27
CPI-1979

Dated at Rhineland, Wis., this 28th day of February, 1979.

Signature Phillip T. Hansen Title Registered Land Surveyor Registration No. S-498

(County Surveyor, Registered Land Surveyor, or other duly authorized official)

Office of Register of Deeds, County of Oneida, I hereby certify that the within instrument was filed in this office for record on the 13th day of March, 1979 at 1:30 o'clock M.

Doree Leverage Kuehn
(Register of Deeds)

By Doree Leverage Kuehn Deputy

3511271010