

CERTIFIED LAND CORNER RESTORATION

Index No. 7-14

State of Wisconsin

County of Oneida } ss.

I Phillip T. Hansen, do hereby certify that on the 6th day of February, 1979, I ~~restored~~ re-established the WC 1/16 corner of Section 27 Township 35, North, Range 11, East, Fourth Principal Meridian, as described hereon, and that from this evidence I established a new monument and accessories as described hereon to perpetuate the original location of this corner.

Resident witnesses:
Glen Barker
Herb Wagoner

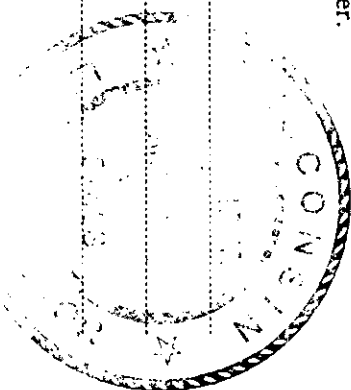

History of original corner establishment:

Description of corner evidence found:
No evidence of any corner found. Corner established by traverse and computation. Computed distance from W 1/4 corner section 27 to C 1/4 is 2726.969' at bearing S 87-48-46 E.
Set WC 1/16 corner at 1363.484' intermediate.

Description of monument and accessories I established to perpetuate the original location of this corner.
Set a 1 1/2" iron pipe with 2" brass cap projecting 18" above ground. Cap stamped:
Marked NBT's -
Red Pine 5" S9°W 14.95' scribed 1/16 BT.
Red Pine 5" N69°W 22.55' scribed 1/16 BT.
S498
T35N R11E
WC 1/16 S+27
CPI-1979

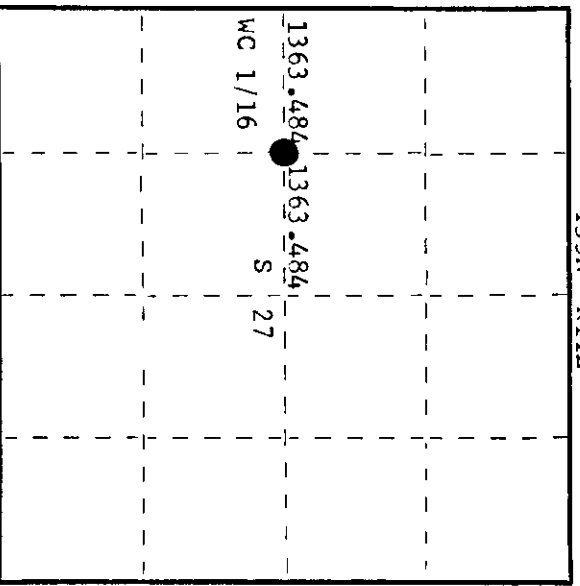

○ = Corner monument restored.

Dated at Rhineland, Wis., this 22nd day of February, 1979.
Signature: Phillip T. Hansen Title Registered Land Surveyor Registration No. S-498
(County Surveyor, Registered Land Surveyor, or other duly authorized official)

Office of Register of Deeds, County of Oneida, I hereby certify that the within instrument was filed in this office for record on the 13th day of March, 1979 at 1:30 o'clock P. M.
Dona LeAnne Kuehn
(Register of Deeds)

By _____ Deputy

351127 2030